

Downloaded Catalog Table of Contents

Each Section has its own Table of Contents as well
(Each section can be individually downloaded)

<u>Item</u>		<u>Pages</u>
Policies and Procedures, Options, Colors, and Finishes		1—24
Beds, Daybeds, and Bunk beds	Section 1	25—40
Bookcases and Chests	Section 2	41—48
Cabinets	Section 3	49—60
Chairs	Section 4	61—64
Chest of Drawers	Section 5	65—76
Desk and Office	Section 6	77—86
Entertainment Centers	Section 7	87—98
Buffets, Islands, and Huntboards	Section 8	99—104
Tables	Section 9	105—114
Side tables and End tables	Section 10	115—122
Mirrors, Benches, and Screens	Section 11	123—128
Wall Units and Armoires	Section 12	129—138

Price List - Please download from the Dealer Site at www.seabrookclassics.com.

Contact us at 843-466-0242 or send an email to
info@seabrookclassics.com for user name and password
if you don not have them or would like access.

To Order:

1. Contact us, give us desired item number, options, and colors
2. We will email you, or fax you a quote
3. If customized, we will quote, then generate CAD drawings, and revise till approved.
4. You then approve quote (and CAD if needed) via signed order form and fax to us
5. Upon receipt of approved order and 50% of total cost, we then put into production
6. One week prior to completion, we will contact you for final payment and shipping directions

Lead times are 6 to 10 weeks depending on size of order and season



www.seabrookclassics.com
www.coastalwoodcraft.com

Phone: 843.466.0241 Fax: 843.466.0288

By Coastal  Woodcraft

Visit us at www.seabrookclassics.com



by **Coastal**  **Woodcraft**

Orders or Inquiries
843.466.0241

Fax
843.466.0288

Email
Info@seabrookclassics.com



www.seabrookclassics.com
www.coastalwoodcraft.com

Phone: 843.466.0241 Fax: 843.466.0288

By **Coastal**  **Woodcraft**

Visit us at www.seabrookclassics.com

Dealer Catalog



by **Coastal**  **Woodcraft**

Introduction	2,3
Ordering and Shipping	4,5
Shipping Policy	6
About our Furniture	7
Furniture Finishing Standards	7
Warranty	8
Stocking Dealer Program	9
CAD Drawings	10
Cancellations	10
Warranty and Repair Policy Statement	11
CAD Drawing Example	12
Door Options	14
Monogramming	15
Finishes	16
Standard Colors—Page 1 of 2	17
Standard Colors—Page 2 of 2	18
Level II Finishes	19
Level III Finishes	20
Stain Grade Finishes	21
Wood and Cottage Style Furniture Notes	22
Furniture Sections	
Price List—Appendix A	



www.seabrookclassics.com

www.coastalwoodcraft.com

Phone: 843.466.0241 Fax: 843.466.0288

By **Coastal**  **Woodcraft**

Page 3 of 138

The Lowcountry...

Growing up in the Midwest has its ups and downs; the long cold winters, short hot summers, miles and miles of corn and wheat fields, and the occasional vacation to see family in North Dakota. The beach and the ocean breeze was something experienced watching Flipper and Gilligan's Island. Once out of college I had the chance to visit the coast of South Carolina and Georgia and was hooked from that day forward. Now twenty years later, my children live a life I only dreamed of as a child. The beach, the trees, the ocean all just minutes away and yes, the occasional 'Flipper' passes by the dock.



The place we live is known as the Lowcountry. Islands here are not like Gilligan's Island but rather, they are areas of land just a few feet above sea level covered with ancient angel oak trees dripping with Spanish moss, Palmetto palm trees, and lush green underbrush. They're separated by vast saltwater marshes with winding rivers and tidal creeks teeming with wildlife. The mood here is laid back and moves at a more comfortable pace. The air is heavy and smells of salt. Just past the marshes and the barrier islands are the ocean and all its mysteries. The Lowcountry is not just a description of land, it also describes a state of mind. It's relaxing, tranquil, and a place we call home.



In my 20th year in the Lowcountry, I still notice the palm trees and the Spanish moss, and still appreciate the marshes and stunning beauty that surrounds me. It is this life and this area that inspires our furniture designs.

When you place a piece of Seabrook Classics furniture in your home, you get a small piece of the Lowcountry too. The subtle, simple design characteristics fit the most formal rooms and the informal rooms as well. Maybe its just an accent piece, a buffet or armoire, or an entire bedroom suit you choose. Whatever it may be, we know when you look at it you'll be reminded of the Lowcountry. Peace, tranquility, a comfortable pace, and a more comfortable place.

This catalog is a representation of what we have to offer. You can view additional furniture and paint colors at our website:

www.seabrookclassics.com.



www.seabrookclassics.com
www.coastalwoodcraft.com

Phone: 843.466.0241 Fax: 843.466.0288

By **Coastal**  **Woodcraft**

Construction and Customization...

We use the bench method of construction. This means that each piece of furniture we produce is built individually by a skilled craftsman from start to finish. This allows us to customize each piece to the specific desires of the customer. From a simple modification of one of our existing designs to a complete custom piece with included CAD renderings, we strive to meet your every need.



Head Carpenter David Pickel

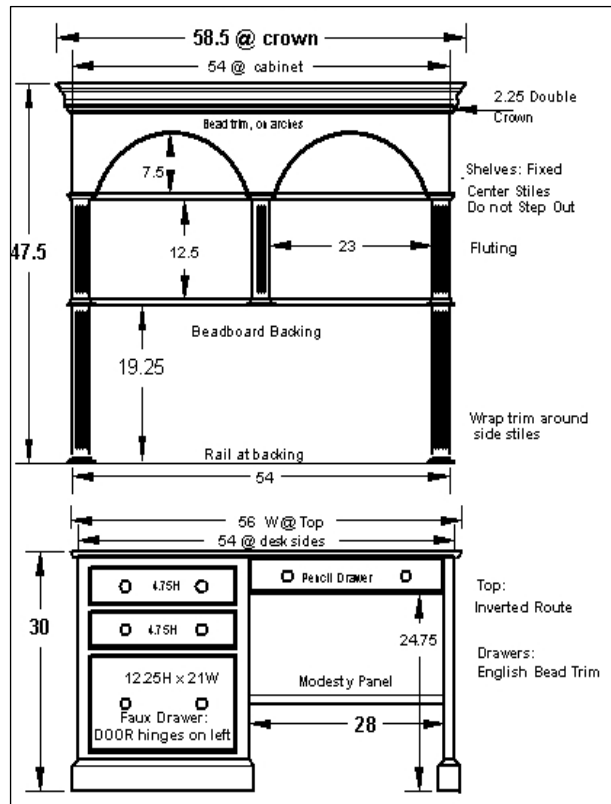

Finishes...

Our painted finishes feature over 30 colors which can be combined creating a "rubbed finish", bringing multiple colors into one piece. Our stain finishes range from a whitewashed finish to our classic Sealed English finish. Our painted pieces are constructed of Poplar and Birch. Our stain grade items feature White Pine, a warm wood found in the Lowcountry. We also offer many of our designs in premium hardwoods from Maple, Cherry, and antique Heart Pine.



Head Painter Dan Rush



www.seabrookclassics.com
www.coastalwoodcraft.com

Phone: 843.466.0241 Fax: 843.466.0288

By Coastal Woodcraft

Ordering and Shipping

Orders

To receive wholesale pricing, you must furnish us with a copy of your resale business license. *There is no minimum order quantity.* We offer a Stocking Dealer program for customers who wish to stock our furniture in showrooms. Please refer to the Stocking Dealer Program in this catalog.

Terms

- We accept Visa, MasterCard, and checks.
- We require a 50% down payment at the time of order. We do not take 100% deposits. Our standard lead time is 8 – 10 weeks, with an additional 5 – 15 day ship time.
- Orders go to production upon receipt of a confirmed and signed job order and 50% payment is received. This is when we begin our lead time schedule.
- We will contact you when your order is being packed for shipping for the balance due. Upon receipt of the balance due, we will ship your order.

RUSH Lead Times

We offer a "RUSH Lead Time" program. RUSH lead times are for 6 weeks or less, and we *guarantee* our RUSH Lead Times. For your order to be rushed, there is a 10% fee added to the total order amount, and the RUSH fee is collected up front. If we do not have your order ready for shipment on the date we guarantee, we will refund your RUSH Fee.

Example of RUSH Lead Time and Refund

Order total = \$1,000 and received on signed and confirmed on August 1st, and a 4 week lead time is requested. Total cost of order for a 4 week lead time is \$1,100. (Total plus 10%)

We quote a ship date of August 28th. We collect a 50% deposit, plus 10% RUSH fee up front. Total paid up front will be \$600 with a balance due on August 28th of \$500 when your furniture order is ready to ship.

If we do not make your RUSH ship date, and the furniture is not ready until August 29th, your RUSH fee is waived, and your balance due is now \$400.

****PLEASE NOTE:** We can not guarantee the date your order will leave our docks with the shipper; we can only guarantee what is in our control. Please add 5-15 days for delivery.

If we are one day late on your ship date, you get a RUSH fee refund – no questions asked.



www.seabrookclassics.com
www.coastalwoodcraft.com

Phone: 843.466.0241 Fax: 843.466.0288

By **Coastal**  **Woodcraft**

Page 6 of 138

Shipping

Through our many years of experience with shipping furniture, we choose to work exclusively with Metropolitan. Metropolitan demonstrates a commitment to excellence in customer service, and provides a wide range of shipping options from simple dock delivery to "White Glove" delivery at competitive industry rates.. All of our shipping quotes are through Metropolitan and our other preferred shippers. Should you have your own shipping preference, quotes and shipping arrangements must be handled through your carrier.

METROPOLITAN WAREHOUSE & DELIVERY

"Since 1989, Metropolitan Warehouse & Delivery has succeeded in becoming the Premier White Glove, In-Home Delivery Company, specifically catering to the High End Furniture, Antiques, and Fine Furniture Manufacturing Industries. With humble beginnings, Metropolitan began with 5 employees and 1 truck. Today, we are a team of 70+ employees, 22 trucks, in three prime locations: Linden New Jersey, High Point North Carolina, and Miramar Florida. Metropolitan Warehouse is proud of our experienced, dedicated, and professional staff and takes pride in the relationships we have built with our loyal Clients, Designer Showrooms, Businesses, and Interior Designers. Understanding, meeting, and exceeding your professional expectations is our # 1 goal. We look forward to getting to know you and thank you in advance for the opportunity to serve your delivery needs with the quality, integrity, and special care that we at Metropolitan so sincerely offer. "

New Jersey	Florida	North Carolina
2565 Brunswick Ave. Building J, Linden NJ 07036 Phone: 800.300.7417 Fax: 866.218.8129	3949 Commerce Pkwy Miramar, FL 33025 Phone: 800.300.7417 Fax: 954.392.4987	1821 Baker Road High Point, NC 27263 Phone: 800.300.7417 Fax: 336.434.4110



www.seabrookclassics.com
www.coastalwoodcraft.com

Phone: 843.466.0241 Fax: 843.466.0288

By **Coastal**  **Woodcraft**

Shipping Policy

Please review these instructions carefully and forward to your clients as needed.

Definitions...

- Lead Time: - time it takes for your furniture to be completed, boxed, and ready for shipping
- begins on the date we have received 50% down payment and signed/
confirmed order and ends when merchandise is ready for carrier pick up.
- Ship Date - date your order will be completed, boxed and ready for pick up by our carrier.
- Delivery - merchandise arrives at its final destination.
- Ship time - time it takes to go from our facility to its final destination, typically 5 to 15 days
- Bill of Lading - List of items shipped, "shipped from" address and "shipped to" address, and
acknowledgement signature of receipt of merchandise in good condition.

When your order is received

- All merchandise must be opened and inspected for damage at the time of delivery and *prior to signing the Bill of Lading.*
- If you are unable to inspect your order at the time of delivery, please write on the Bill of Lading "Subject to Inspection" above your signature.

**If you sign the Bill of Lading without inspecting or noting "Subject to Inspection" you are accepting the delivery and signing that it is being received in good condition. In this case, any damage - including concealed damage - is your responsibility to claim with the shipping company.

If the merchandise is:

- Damaged – regardless of how it occurred
- Not what you ordered
- Incorrect in any way

*Refuse the delivery and contact us immediately -
It will be returned to us for repair and/or replacement.*

- If you have the ability to have the furniture repaired locally please accept the furniture noting the damage on the Bill of Lading and contact us immediately for further instructions.
- If delivery is refused, note the damage on the Bill of Lading and Coastal Woodcraft, LLC will handle all claims with the carrier and will re-ship as soon as possible.
- If damaged merchandise is accepted or the received merchandise is incorrect and is accepted, it will be your responsibility to manage all claims or have the item shipped to Coastal Woodcraft for repair or replacement. Charges may apply.



www.seabrookclassics.com
www.coastalwoodcraft.com

Phone: 843.466.0241 Fax: 843.466.0288

By Coastal  Woodcraft

Page 8 of 138

About Our Furniture

Seabrook Classics furniture is built to exacting standards by individual craftsmen. Many of our finishes are ordered "distressed" or "rubbed" as the cottage style of furniture is intended to appear older and worn in many cases. Over the years, your furniture will become distressed and gain its own character.

Furniture Finishing Standards

Coastal Woodcraft finishes are all waterborne. We do offer eco-friendly finishes. Please specify eco-friendly paints when ordering. Eco-friendly products require a separate quote.

We utilize 4 finish levels in our finishing process:

A. Furniture Faultless - our best finish with all holes filled and no imperfections noticeable – used on all of our pieces on at least 3 sides and all interiors

B. Furniture Limited - finished well, but some slight faults may be noticed upon close inspection – used primarily on the backs of headboards and footboards where close inspection is not normal

C. Rough Finished – generally sprayed with the color of the piece – used primarily on the backs of items which are made to be placed against a wall such as a nightstand or entertainment center.

D. Unfinished – raw wood

All furniture is finished "Furniture Faultless" on 3 sides, and the back is "Rough Finished" unless a different finish level is specifically requested at the time an order or contract is signed.

**You may request specific finish levels for a particular item if you know it is going to be in a setting where all 4 sides will be exposed. For example, if you order a nightstand, you may specify that it be furniture faultless on all 4 sides instead of the standard 3 (there will be a slight up-charge for this).

Hinges

Our standard finishing process produces painted hinges. They are painted the same color the piece is painted. It is usual and customary that the paint on the hinges may crack and flake off as the piece ages. If you desire hinges that are not painted, please note this in your order. There is an additional fee of \$5 per hinge if you choose to not have them painted. Bare hinges are dark brown in color. If you desire designer hinges, each order will require an individual quote.



www.seabrookclassics.com

www.coastalwoodcraft.com

Phone: 843.466.0241 Fax: 843.466.0288

By Coastal  Woodcraft

Warranty and Care

Seabrook Classics furniture is manufactured with constant quality control inspections. Changes in atmospheric conditions can affect wood products. Extreme changes in humidity may cause warping, cracks, and splits. Uneven surfaces can cause doors to become out of square and sag.

The warranty expressed and implied is limited to one year against defects in workmanship and material. Furniture damaged in shipping is not included in the warranty. Please refer to our shipping policy with regard to shipping damages.

The warranty does not apply to damage that may result from neglect, accidental or intentional damage (after production distressing), exposure to extremes in temperature and humidity and alteration or abuse of the product.

Furniture ordered **unfinished** does not come with a warranty and Coastal Woodcraft is not responsible for **custom paint finishes**.

Should your furniture become damaged as a result of workmanship or materials, please supply a detailed description and digital photographs. Claims must be made by the dealer. Once damage is determined to be workmanship or material in nature, Coastal Woodcraft will make the repair or replacement or approve a local vendor to do so. We must authorize this in writing prior to commencement of repair by a local vendor. Coastal Woodcraft will not reimburse unauthorized repair costs under any circumstances. Coastal Woodcraft does not warranty local vendor work completed.

Care and Finish

Painted Finish – Clean with slightly damp cloth only – Wipe dry.

Stained Finish – Clean with slightly damp cloth only. Wipe dry.

Stained Finishes

No two trees are exactly alike and each cut of wood will take stain differently. Variations between samples and finished goods should be anticipated. This is due to aging of the samples and cuts of wood in the finished product. Unless otherwise specified in the order, stained wood, wood table tops, and heart pine accented pieces will have visible knots. **If you do not desire visible knots in the finished product – this must be noted at the time of order and may require additional charges.**

SEE STATEMENT OF WARRANTY AND LIMITS FOR REPAIRS ON PAGE 11.



www.seabrookclassics.com

www.coastalwoodcraft.com

Phone: 843.466.0241 Fax: 843.466.0288

By Coastal  Woodcraft

Page 10 of 138

Stocking Dealer Program

While there is no minimum order in purchasing, some decorators and dealers may choose to become a part of our "Stocking Dealer" program. This program has many benefits:

Stocking Dealer Prices

Significantly lower than our standard wholesale pricing.

Referrals

Coastal Woodcraft does not sell directly to the public. We rely on our dealers and decorators to sell and promote our furniture locally. However, we have a national advertising campaign that is dedicated to directing interested consumers to our stocking dealers. We have an active referral program in place, including the "dealer locator" on our website www.seabrookclassics.com. General inquires to our facility are referred to the nearest stocking dealer.

Requirements to become a Stocking Dealer

- Stocking Dealers must complete the Seabrook Classics Dealer application and be approved by Coastal Woodcraft, LLC as a Stocking Dealer.
- There is an opening order minimum of \$5,000 (at stocking dealer prices) and Stocking Dealers are required to purchase an annual volume of \$15,000 (at stocking dealer prices) to remain a Stocking Dealer.
- Stocking Dealers must maintain a showroom inventory minimum of \$5000 (at stocking dealer prices) of Seabrook Classics product at all times.
- Stocking Dealers must dedicate the appropriate amount of showroom space to our product to allow it to show well. We recommend at least 200 square feet. This will allow the consumer to get a sense of the quality of our construction and our materials, as well as the overall look of the line.

Out of fairness to our current Stocking Dealers, we cannot offer stocking dealer prices unless you meet all requirements.



Framed Dealer Color Board

Color boards available for \$75. Each board is monogrammed with the lettering of your choice in our 4 most popular monogram fonts. Each color chip measures 2.5"W x 2.0"H.

Stocking Dealers are given a complimentary monogrammed color board with their opening order. (beginning April, 2011)



www.seabrookclassics.com

www.coastalwoodcraft.com

Phone: 843.466.0241 Fax: 843.466.0288

By Coastal  Woodcraft

CAD Drawings and Fees

CAD drawings are provided on all custom pieces. A CAD drawing fee for each piece will be assessed a \$50.00 fee which will be added to the total order amount. This fee includes the initial drawing and all subsequent changes for approval. CAD fees are non refundable. All drawings remain the property of Coastal Woodcraft, LLC.

Once a final approval is provided by the customer, any changes to the final approved order *after the piece is placed into production* will be assessed an additional \$50.00 fee. Custom pieces will not be placed into production and lead times can not be quoted until a final approval signature is received on the final CAD drawing.

See CAD example on Page 12.

CANCELLATION POLICY

WE DO NOT CARRY ANY ITEMS IN STOCK – ALL ITEMS ARE BUILT TO ORDER

Cancellation of orders must be submitted in writing

Orders canceled within 2 weeks of the order date will receive a full refund.

Orders canceled within 2-6 weeks of the order date will have a penalty of 25% of the order total. The penalty amount will be held as a credit on your Seabrook Account for 90 days for use on a future order. After this time the penalty amount will be forfeited. Orders canceled after 6 weeks of the order date OR orders not accepted and paid in full within 90 days of completion will be forfeited and the 50% deposit lost. Refunds will be processed within 2-3 weeks of the request.



www.seabrookclassics.com

www.coastalwoodcraft.com

Phone: 843.466.0241 Fax: 843.466.0288

By **Coastal**  **Woodcraft**

Warranty Statement and Repair Policy

As a natural product, wood furniture will, from time to time, crack and warp due to changes in climate, humidity, and temperature. We make all attempts to manufacture our furniture with this in mind, but by its very nature, solid wood furniture can be unpredictable. All furniture is inspected prior to leaving our plant, and we ensure all doors are straight, drawers glide smoothly and fit snugly, and joinery is sound. We stand by our products and offer the following as a statement of warranty and repair policy.

Door warping within 12 months of delivery. The owner of the furniture is authorized to remove the door(s) and ship to us. We will rebuild the doors, paint, and return, with return shipping to the owner paid by Coastal Woodcraft, LLC. Labor for installation allowance is \$25 per door. Please note, if one door is warping, both doors must be removed and sent.

Door warping beyond 12 months from delivery. The owner is authorized to remove the doors. Coastal Woodcraft, LLC will rebuild the doors and paint at no cost to the owner. Shipping and installation is the responsibility of the owner.

Repairs to cabinet cases or accent furniture. Repairs to cabinets or accent furniture must have an estimate generated and sent to Coastal Woodcraft, LLC, prior to work commencement. Coastal Woodcraft, LLC will review the estimate, and provide reasonable approval in writing. Once repair work is completed, Coastal Woodcraft, LLC will pay the contractor invoice, or reimburse the owner upon receipt of a paid invoice for the repair work paid by the owner to the contractor that provided the estimate.

Paint for repair work. Coastal Woodcraft, LLC will provide 6 ounces of paint at no cost to the owner. However, due to onsite condition variability, (i.e. aging, sun bleaching, etc.) we cannot guarantee a perfect match.

****Repair work completed without written estimate from the contractor and written approval for work commencement from Coastal Woodcraft, LLC will not be reimbursed under any circumstances.**



www.seabrookclassics.com

www.coastalwoodcraft.com

Phone: 843.466.0241 Fax: 843.466.0288

By Coastal  Woodcraft

Page 13 of 138

Visit us at www.seabrookclassics.com
 Example of custom CAD.
 CAD drawings will be provided by request

CAD fees are \$50 per furniture piece, regardless of the number of revisions.

Reised # 1 Version: DRAFT	Custom CAD: 536 Plantation Linen Press For: Lester Tester Interiors, LLC	Page 1 of 1
------------------------------	---	-------------

Item #536 Custom Linen Press

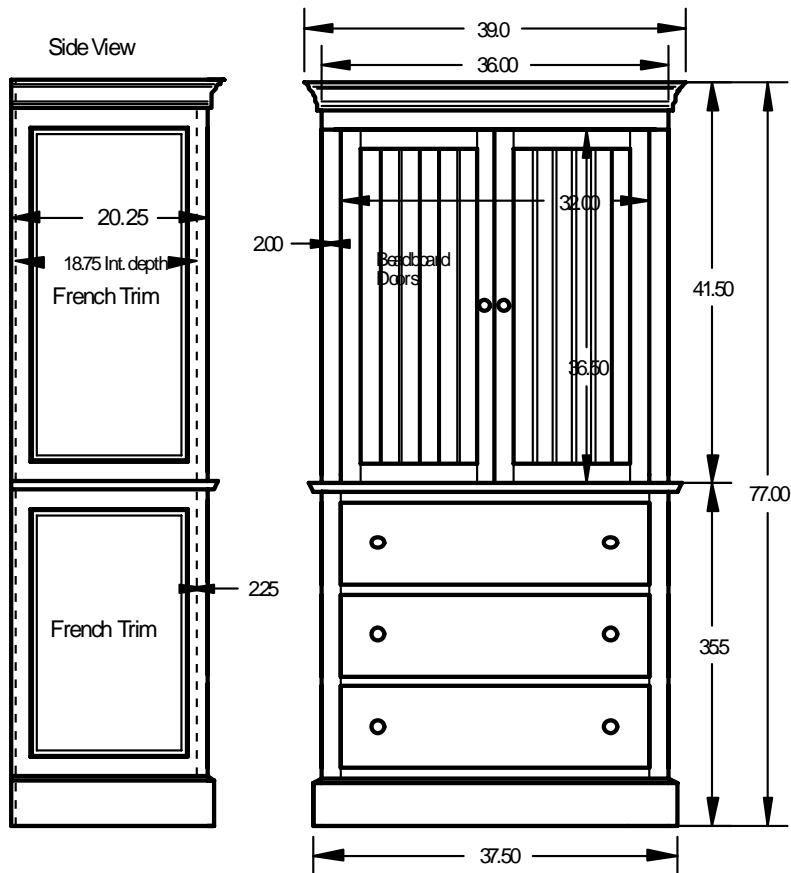

Approval Signature: _____ Date: _____

Signature indicates approval of drawings as shown. If changes are required, please note changes on drawing and fax back to 843-466-0288. If drawing meets expectations, please sign and fax back to same number.

Copyright Coastal Woodcraft, LLC makers of Seabrook Classics Furniture.
 All rights reserved.



www.seabrookclassics.com
www.coastalwoodcraft.com

Phone: 843.466.0241 Fax: 843.466.0288

By Coastal Woodcraft

Door Options
-
Monograms
-
Finish Options
-
Color Options



www.seabrookclassics.com

www.coastalwoodcraft.com

Phone: 843.466.0241 Fax: 843.466.0288

By **Coastal**  **Woodcraft**

Standard Door Options

Coastal Woodcraft offers a variety of door styles to choose from. Bermuda, Plantation, and Seagrass doors, unless identified as standard, are charged as indicated.

Please specify your preferred door style when placing your order.

All single doors hinged on LEFT unless otherwise specified.

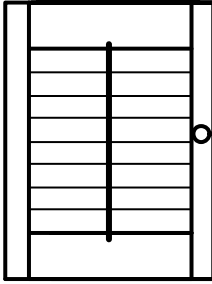

Plantation Shutter
(Functional)

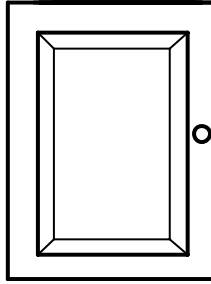

Raised Panel

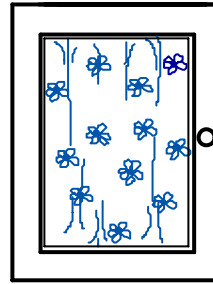

Open Panel with Dowel
Curtain Rods

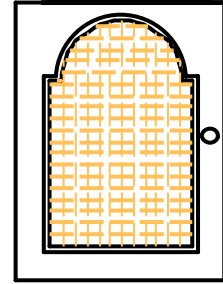

Arched Seagrass
(Squared Available)
\$25 / door

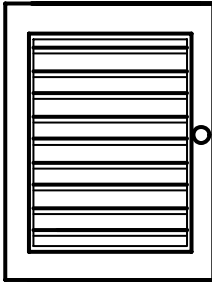

Bermuda Shutter
\$35 / door

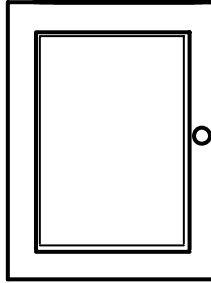

Flat Panel with Routed
Interior Edge

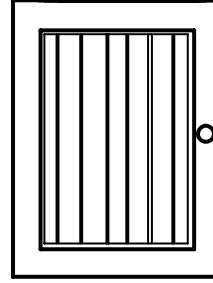

Squared Bead Board
(Arched Available)

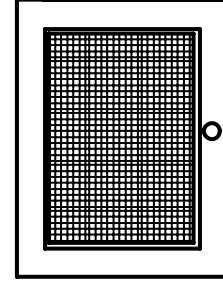

Carolina Basket Weave

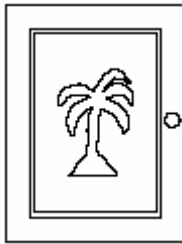
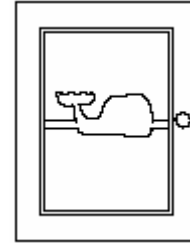
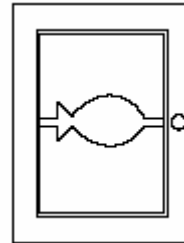
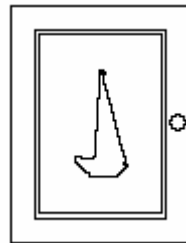
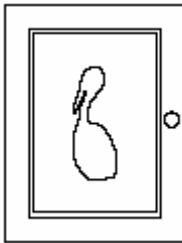

Door Cut-Outs

- Palm
- Pelican
- Sailboat
- Fish
- Whale



www.seabrookclassics.com
www.coastalwoodcraft.com

Phone: 843.466.0241 Fax: 843.466.0288

By **Coastal Woodcraft**

Monograms

Monograms are available on nearly all items. Our monograms are stenciled and hand painted, ensuring long lasting durability.

Select your font and style. Below are a few styles we have available. Please let us know if you would like a different style and we can send you a palette of your specific initials in different styles from which you may choose.



DIAMOND



SCRIPT



OVAL



VINE



OCTOGRAM

- Sizes will vary depending on item (up to 9 ")
- Designate style option and placement at time of order
- Provide the left, middle, and right letters for the initials
- All monograms available in any of our solid paint finishes



www.seabrookclassics.com
www.coastalwoodcraft.com

Phone: 843.466.0241 Fax: 843.466.0288

By Coastal Woodcraft

Seabrook Classics Finishes

Seabrook Classics furniture can be purchased with any one of our 5 finishes. All finishes are water born Sherwin Williams lacquer. They have proven to withstand the test of time and are remarkably durable and resilient.

Custom colors can be utilized; however, we cannot guarantee the finish of colors or paint finishes that are not part of our standard paint brand, or deviate from our standard finishes.

Custom colors are charged at \$50/gallon.

Level I

A Level I finish is a single solid color chosen from our palette of over 40 colors. Each piece is sanded, primed, and then finished with multiple coats of the color of your choosing. All furniture is priced with a Level I finish.

Level II

Our Level II finish is known as a "Rubbed" finish. This is a proprietary method of finishing where a complimentary base color is chosen, and a top color is applied over the base color. We then "rub" the edges and details of the piece revealing the complimentary undercoat. *This method of finishing should not be confused with any other type of commercially available or defined "rubbed" finish.* Any color of our palette can be chosen as either the base or top coat, which leads to an infinite number of combinations! Level II finishes incur a 10% premium.

Level III

Similar to our "Rubbed" finish, but this level has three (3) colors applied and the edges are then rubbed revealing the 2 base coats. Level III finishes incur a 15% premium.

Level IV: Stain Grade Accents

Any piece can have a stain grade white pine or antique heart pine top surface added as an accent. Examples would be a painted buffet with a heart pine work surface or a table with a stained top.

Level V: Stain Grade Construction

Any of our pieces can be built in stain grade wood from white pine, antique heart pine, walnut, or cherry. Stain grade pieces are finished with a semi-gloss clear coat for preservation.

Notes about choosing your finish:

We have found when choosing a piece that will serve the hotel industry, be placed in a child's room, or be placed in an area of high use, the **Level II** finish has proven the most popular and satisfying to our clients.

Cottage style furniture is intended to weather over time revealing its own character. However, as the furniture wears, and paint is chipped away (as happens with all painted furniture), our proprietary rubbed finish provides the client an element of control with how the piece weathers.

All finished and painted pieces are shipped with a 3 ounce sample of paint.



www.seabrookclassics.com

www.coastalwoodcraft.com

Phone: 843.466.0241 Fax: 843.466.0288

By **Coastal**  **Woodcraft**

Page 18 of 138

Standard Color Palette of Seabrook Classics – Page 1 of 2

Colors do not reproduce well in print. Please refer to our paint chips before final choices are made. We can mail up to 3 paint chips free of charge to you or your client.



Bermuda

Hibiscus

Camelia

Flamingo



Sunset

Jambalaya

Fuzzy Peach

Coral Reef



Lobster Pot

Seabrook Red

Burgundy

Brick Red

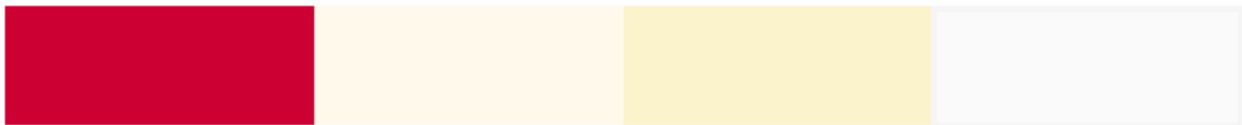

Gumbo

Antique White

Carolina Khaki

Oyster Roast



Victorian White

Sun Porch

Seabrook Yellow

Ricefield



Seabrook Black

Charleston Green

Billiard Green

Seabrook Green



Pale Green

Wetlands

Veranda

Sea Mist



www.seabrookclassics.com

www.coastalwoodcraft.com

Phone: 843.466.0241 Fax: 843.466.0288

By **Coastal Woodcraft**

Standard Color Palette of Seabrook Classics – Page 2 of 2

Colors do not reproduce well in print. Please refer to our paint chips before final choices are made. We can mail up to 3 paint chips free of charge to you or your client.

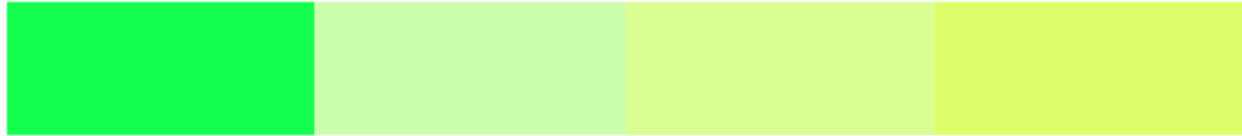

Lily Green

Margarita

Palm

Lime Zinger



Mint Julip

Island Blue

St. Croix

Gullah Blue

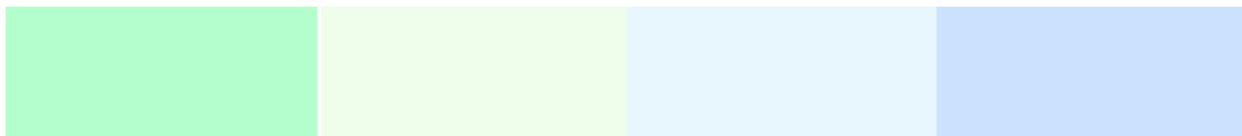

Frogmore

Key Lime

Sailing

Beach



Bayside

Coastal

Regatta

Seabrook Blue



Wisteria



www.seabrookclassics.com

www.coastalwoodcraft.com

Phone: 843.466.0241 Fax: 843.466.0288

By **Coastal Woodcraft**

Level II Finish Examples

Colors do not reproduce well in print. Please refer to our paint chips before final choices are made. We can mail up to 3 paint chips free of charge to you or your client.

Below are just a few of the over 13,000 combinations that can be created. Please specify a "Light", "Medium", or "Heavy" rub at time of order.

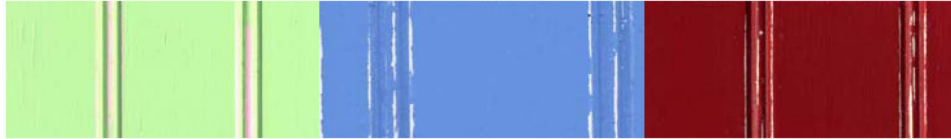

Margarita over Hibiscus

Bayside over Victorian White

Gumbo over Natural



Regatta over Natural

Sunset over Ricefield

St. Croix over Oyster

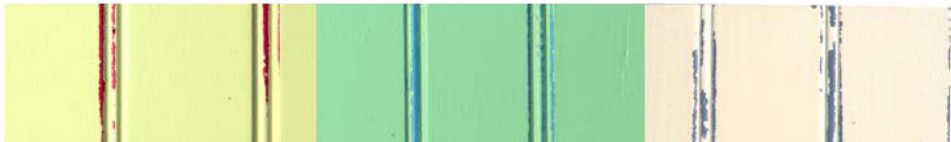

Palm over Hibiscus

Frogmore over Bayside

Antique White over Seabrook Blue



Seabrook Black over Tan

Victorian White over Seabrook Blue

Beach over Oyster



Carolina Khaki over Brown

Bermuda over Sailing

Oyster over Frogmore



www.seabrookclassics.com
www.coastalwoodcraft.com

Phone: 843.466.0241 Fax: 843.466.0288

By **Coastal Woodcraft**

Level III Finish Examples

- Weathered White
- Seabrook Classics' Standard Multi-Color
- Shrimp n' Grits
- Create your own Multi Rubbed Finish: Select a top finish and two or three additional colors to show through as the rub.
- Create your own 2 color rubbed finish with an Antique Glaze: See example of Pale Green over Brown with an Antique Glaze



Seabrook Standard Multi-Color
(Antique White over Seabrook Green, Red, and Yellow)



Shrimp n' Grits
(Oyster over Sunset with an Antique Glaze)

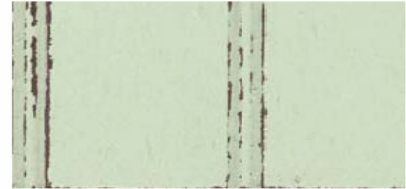

Pale Green over Brown with Antique Glaze



Weathered White
(Victorian White over Brown, with an antique glaze)



www.seabrookclassics.com
www.coastalwoodcraft.com

Phone: 843.466.0241 Fax: 843.466.0288

By **Coastal Woodcraft**

Level IV: Stain Grade top (work surface) in White Pine.

Colors do not reproduce well in print. Please refer to our paint chips before final choices are made. We can mail up to 3 paint chips free of charge to you or your client.



Sealed Whitewash
on White Pine



Distressed Carolina Pine
(A warm finish with
characteristic dents and
scratches on White Pine)

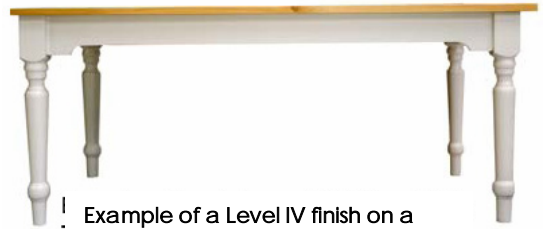

Example of a Level IV finish on a
#128 Farm Table
Top: Sealed English on White Pine



Dark English
on White Pine



Medium English
on White Pine



Sealed English
on White Pine

Please note: These samples were carefully selected to represent different types of finishes. If you desire CLEAR AND KNOT FREE woods, please contact us for a custom quote.



Example of Level 5 on a #217 Cabinet
Entire Item finished in Distressed
Carolina Pine

Level V: Stain Grade item in White Pine, Antique Heart Pine, Walnut, or Cherry



Seabrook Sealed
on Heart Pine



Seabrook Sealed on
Maple



Seabrook Sealed on
Cherry



Medium Dark on
Walnut

PLEASE NOTE: The above samples have been chosen carefully. No two trees are the same, and some variation in color will occur from tree to tree and with aging. We cannot guarantee an exact match. "Knot Free" must be specified at order.



www.seabrookclassics.com
www.coastalwoodcraft.com

Phone: 843.466.0241 Fax: 843.466.0288

By Coastal Woodcraft

Visit us at www.seabrookclassics.com

A Note About Wood Furniture and Cottage Style Furniture

The beauty of wood and most natural raw materials is that it isn't perfect. Wood can contain small knots, mineral streaks, irregular grain, small air cracks, small bug holes and other beauty marks. These are naturally occurring phenomena and are not considered defects.

Wood is hygroscopic which means that it is capable of easily absorbing and releasing moisture in relationship to the ambient air. In short, wood contracts and expands. When work is placed in high stress conditions such as direct sunlight, near a heating or air conditioning duct or in high moisture content environments such as a room with a Jacuzzi or water fountain, the odds are increased that the piece can warp and/or crack due to this expansion and contraction. So be kind to your wood furniture.

Cottage furniture is intended to wear and distress over time. It is this process that gives Cottage Style furniture its character. Our finishes provide a unique opportunity to control what your furniture will look like as the top coat gets nicked and scratched, revealing the under coating of the piece. We encourage you to explore various colors and undercoating colors to develop your own look and feel to your furniture. So above all, HAVE FUN with the colors!

Please review our policies and procedures before you buy. We will be happy to clarify any questions you have.

Our contact numbers are as follows:

Phone
843.466.0241

Fax
843.466.0288

Email
Info@seabrookclassics.com

Please Note:

Our furniture is individually built and finished by our craftsmen in our Sheldon, SC plant. All items ship from Sheldon, SC. Components of our furniture including some hinges, knobs, legs, and pedestals, and some of our chairs are purchased from third parties who may utilize sources for their inventory outside the U.S. Please contact us for any questions, or for detailed information about our third party sources.



www.seabrookclassics.com
www.coastalwoodcraft.com

Phone: 843.466.0241 Fax: 843.466.0288

By **Coastal**  **Woodcraft**

Page 24 of 138

Beds, Daybeds, and Bunk beds

<u>Item</u>	<u>Page #</u>
Item # 26HC Carolina Poster Bed	3
Item # 606 Beadboard Bed	4
Item # 606D Beadboard Daybed	4
Item # 602 Cape Cod Bed	4
Item # 608S Signature Bed	5
Item # 608 Seagrass Bed	5
Item # 608D Seagrass Daybed	5
Item # 680 Dockside Bed	6
Item # 601 Slat Bed	6
Item # 603 Pencil Post Bed	7
Item # 625 Seabrook Canopy Bed	7
Item # 670 Basket Weave Bed	7
Item # 609 Pelican Bed	8
Item # 620 Boat Bed	8
Item # 610 Fish Bed	9
Item # 615 Whale Bed	9
Item # 640 Palmetto Bed	10
Item # 604 Flamingo Bed	10
Item # 614 Oglethorpe Bed	11
Item # 660 Paddle bed	11
Item # 645D Crab Daybed	12
Item # 61 Scroll Side Daybed	12
Item # 691 Classic Bed	13
Item # 605 Seaside Bed	13
Item # SL606 Straight Line Shutter Bed	14
Item # 607 Plantation Bed	14
Item # 692F Seabrook Shutter Bookcase Bed	15
Item # 600A Faux Drawer Front Trundle	15
Item # 630 Hoppin ' John Bunk bed	16
Item # 631 Fish Bunk bed	16



www.seabrookclassics.com
www.coastalwoodcraft.com

Phone: 843.466.0241 Fax: 843.466.0288

By **Coastal Woodcraft**



by **Coastal**  **Woodcraft**

Orders or Inquiries
843.466.0241

Fax
843.466.0288

Email
Info@seabrookclassics.com



www.seabrookclassics.com
www.coastalwoodcraft.com

Phone: 843.466.0241 Fax: 843.466.0288

By **Coastal**  **Woodcraft**



Carolina Lowcountry COLLECTION™

Item # 26HC Carolina Poster Bed



- Tapered Posts
- Headboard, Footboard, Slats & Rails
- 26HCT Twin 84H x 40W x 81.5L
- 26HCF Full 84H x 55W x 81.5L
- 26HCQ Queen 84H x 62W x 86L
- 26HCK King 84H x 77.75W x 86L

Refer to Options Page

Item # 26HCTH

Carolina Poster Bed Twin Headboard

PHOTO *left*

- Victorian White over Camellia
- OPTIONAL Monogram (see below)
- OPTIONAL Palmetto Finials (see below)

Monogram (see Monogram Options Page)

PHOTO *left*

- Vine Style
- Camellia

Palmetto Finial

Item # P2HC (Palmetto Finial—set of 2)

Item # P4HC (Palmetto Finial—Set of 4)

PHOTO *left*

- Victorian White over Camellia



www.seabrookclassics.com
www.coastalwoodcraft.com

Phone: 843.466.0241 Fax: 843.466.0288

By Coastal Woodcraft



Item # 606F
Beadboard Bed Full

PHOTO *above*

- Victorian White

Item # 606D
Beadboard Daybed

PHOTO *right*

- Carolina Khaki



Refer to Options Page

Item # 602
Cape Cod Bed

Tall Headboard with planking detail

- Pineapple Finials
- Complete with Headboard,
Footboard, Slats & Rails
- 602T Twin 57H (at arch) x 41W x 81.5L
 - 602F Full 61H (at arch) x 56W x 81.5L
 - 602Q Queen 63H (at arch) x 63W x 86L
 - 602K King 65H (at arch) x 78.75W x 86L

Item # 602T
Cape Cod Bed Twin

PHOTO *left*

- Seamist



Item # A01 (Pineapple Finial)
Item # A04 (Set of 4)
Small PHOTO



www.seabrookclassics.com
www.coastalwoodcraft.com

Phone: 843.466.0241 Fax: 843.466.0288

By Coastal Woodcraft



Item # 608S
Signature Bed

Customer is Responsible for Fabric and Installation

- Unfinished Flat Panels (not shown) in Headboard for
- Customer's Own Material

Item # 650 Low Profile Footboard

Complete with Headboard, Footboard, Slats & Rails

- 608ST Twin 54H x 41W x 84L
- 608SF Full 54H x 56W x 84L
- 608SQ Queen 54H x 63W x 87.5L
- 608SK King 54H x 78.75W x 87.5L

Daybed (All Daybeds are Trundle Height)

- 608SD Daybed 47H x 45W x 84L

Refer to Options Page

Item # 608ST Signature Bed Twin

PHOTO *LEFT*

- Seabrook Black



Item # 608
Seagrass Bed

- Seagrass Panels
- Seagrass Footboard

Complete with Headboard, Footboard, Slats & Rails

- 608T Twin 54H x 41W x 84L
- 608F Full 54H x 56W x 84L
- 608Q Queen 54H x 63W x 87.5L

608K King 54H x 78.75W x 87.5L

Daybed (All Daybeds are Trundle Height)

- 608D Daybed 47H x 45W x 84L

Refer to Options Page

Item # 608K
Seagrass King Bed

PHOTO *above*

- Flamingo over White

Item # 608D
Seagrass Daybed

PHOTO *right*

- Black over Tan



www.seabrookclassics.com

www.coastalwoodcraft.com

Phone: 843.466.0241 Fax: 843.466.0288

By **Coastal Woodcraft**



Item # 680
Dockside Bed Twin
PHOTO *above*
Mint Julep

**Item # 680
Dockside Bed**

- Rope Trim
- Framed Flat Panel on Headboard & Footboard
- Old South Turned Feet

Complete with Headboard, Footboard, Slats & Rails

- 680T Twin 59H x 41W x 84L
- 680F Full 59H x 56W x 84L
- 680Q Queen 59H x 63W x 87.5L
- 680K King 59H x 78.75W x 87.5L

Daybed (All Daybeds are Trundle Height)

- 680D Daybed 47H x 45W x 84L

Refer to Options Pages



Item # 601T
Slat Bed Twin
PHOTO *above*
Seabrook Red

**Item # 601
Slat Bed**

Complete with Headboard, Footboard, Slats & Rails

- 601T Twin 56H x 41W x 84L
- 601F Full 56H x 56W x 84L
- 601Q Queen 56H x 63W x 87.5L
- 601K King 56H x 78.75W x 87.5L

Daybed (All Daybeds are Trundle Height)

- 601D Daybed 47H @ Post Finial x 45W x 84L
-

Refer to Options Page

If a complete bed is not ordered, headboards will have straight posts without feet, to allow a standard metal bed frame to attach.



www.seabrookclassics.com
www.coastalwoodcraft.com

Phone: 843.466.0241 Fax: 843.466.0288

By Coastal Woodcraft



**Item # 603
Pencil Post Bed**

- Tapered Posts
- Complete with Headboard, Footboard, Slats & Rails
- 603T Twin 84H x 40W x 81.5L
- 603F Full 84H x 55W x 81.5L
- 603Q Queen 84H x 62W x 86L
- 603K King 84H x 77.75W x 86L

Refer to Options Page
**Item # 603K
Pencil Post Bed King**
PHOTO left — Seabrook Black



**Item to Right # 625
Seabrook Canopy Bed**

- French Trim Panels on Headboard & Footboard
- Square Posts with Turned Feet Below & Finials Above
- Complete with Headboard, Footboard, Slats, Rails & Tester
- 625T Twin 83H x 41W x 84L
- 625F Full 83H x 56W x 84L
- 625Q Queen 83H x 63W x 87.5L
- 625K King 83H x 78.75W x 87.5L

Shown: Queen Size, in Victorian White



**Item # 670
Basket Weave Bed**

- Tapered Posts
- Complete with Headboard, Footboard, Slats & Rails
- 670T Twin 75H x 41W x 81.5L
- 670F Full 75H x 56W x 81.5L
- 670Q Queen 75H x 63W x 86L
- 670K King 75H x 78.75W x 86L

**Item # 670T
Basket Weave Bed Twin**
PHOTO left - Seabrook Black



www.seabrookclassics.com
www.coastalwoodcraft.com

Phone: 843.466.0241 Fax: 843.466.0288

By **Coastal Woodcraft**

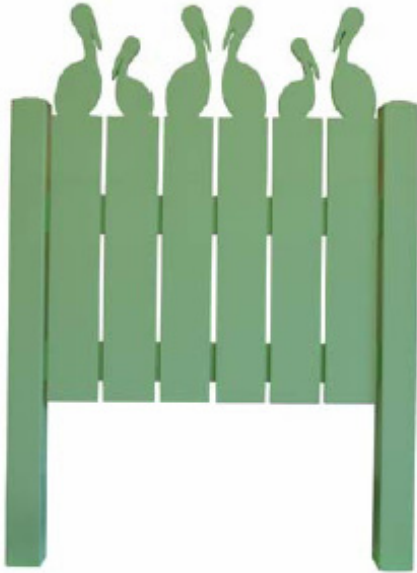

Item # 609TH
Pelican Bed
PHOTO *Above* shown in Lily Green

Item # 609
Pelican Bed

Complete with Headboard, Footboard, Slats & Rails

- 609T Twin 58.5H x 41W x 84L
- 609F Full 58.5H x 56W x 84L
- 609Q Queen 58.5H x 63W x 87.5L
- 609K King 58.5H x 78.75W x 87.5L

Daybed (All Daybeds are Trundle Height)

- 609D Daybed 48H x 45W x 84L

Item # 609D

Pelican Daybed shown in Palm
PHOTO *Below*

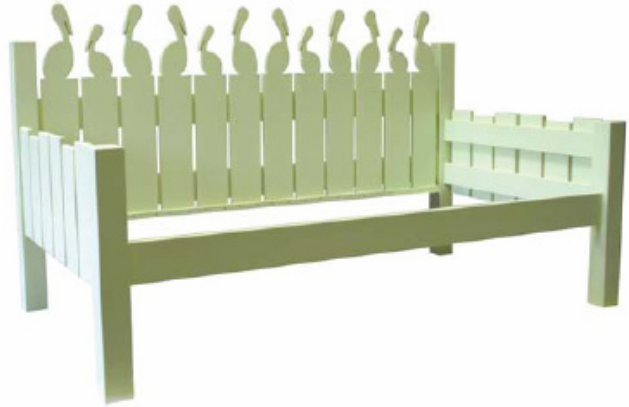

Item # 620TH
Boat Bed
PHOTO *Above* shown in Coastal

Item # 620
Boat Bed

Complete with Headboard, Footboard, Slats & Rails

- 620T Twin 58.25H x 41W x 84L
- 620F Full 58.25H x 56W x 84L
- 620Q Queen 58.25H x 63W x 87.5L
- 620K King 58.25H x 78.75W x 87.5L

Daybed (All Daybeds are Trundle Height)

- 620D Daybed 48H x 45W x 84L

Item # 620D
Boat Daybed

PHOTO *Right* (shown in old cut out
boat pattern) in Seabrook Red



www.seabrookclassics.com
www.coastalwoodcraft.com

Phone: 843.466.0241 Fax: 843.466.0288

By Coastal Woodcraft

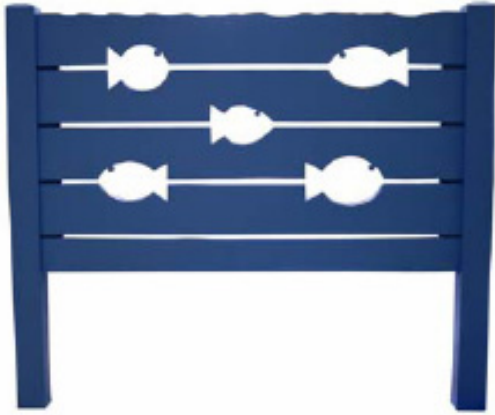

**Item # 610
Fish Bed**

- Slat Headboard with Fish Cut-outs
- Item # 650 Low Profile Footboard
- Complete with Headboard, Footboard, Slats & Rails
- 610T Twin 48H x 41W x 84L
- 610F Full 48H x 56W x 84L
- 610Q Queen 48H x 63W x 87.5L
- 610K King 48H x 78.75W x 87.5L
- Daybed (All Daybeds are Trundle Height)
- 610D Daybed 42H x 45W x 84L

*Refer to Options Page
See Fish Bunk Beds, page 16*

Item # 610F
Fish Bed Full Headboard
PHOTO above in Coastal

Item # 610D
Fish Daybed
PHOTO right in Bermuda

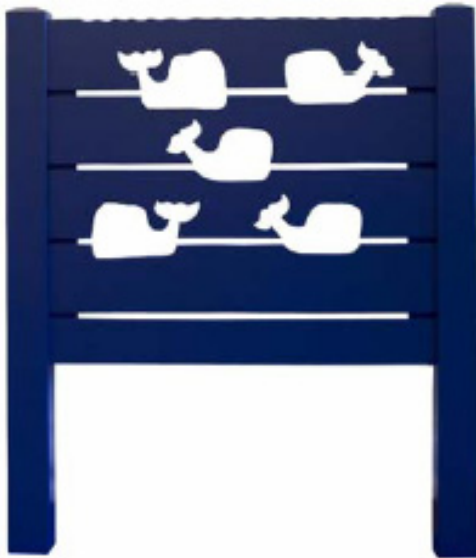
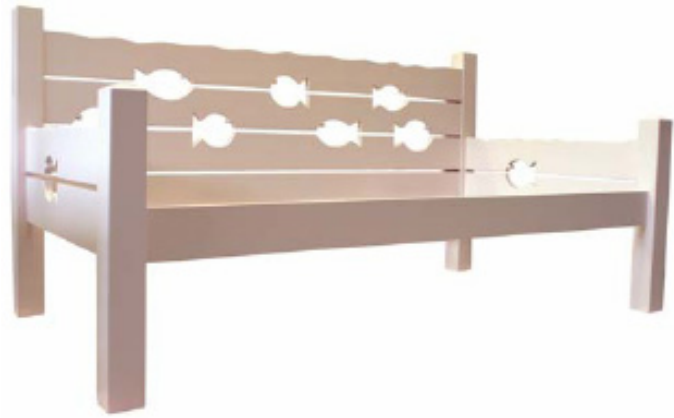

**Item # 615
Whale Bed**

- Slat Headboard with Whale Cut-outs
- Item # 650 Low Profile Footboard
- Complete with Headboard, Footboard, Slats & Rails
- 615T Twin 48H x 41W x 84L
- 615F Full 48H x 56W x 84L
- 615Q Queen 48H x 63W x 87.5L
- 615K King 48H x 78.75W x 87.5L
- Daybed (All Daybeds are Trundle Height)
- 615D Daybed 42H x 45W x 84L

Item # 615TH
Whale Bed Twin Headboard
PHOTO above in Regatta

Refer to Options Page



www.seabrookclassics.com
www.coastalwoodcraft.com

Phone: 843.466.0241 Fax: 843.466.0288

By **Coastal Woodcraft**

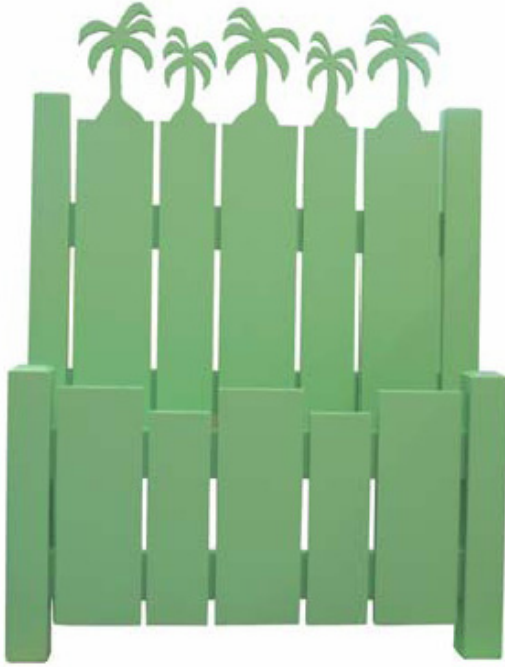

Item # 640T
Palmetto Bed Twin
PHOTO *above* in Margarita

Item # 640
Palmetto Bed

Complete with Headboard, Footboard, Slats & Rails

- 640T Twin 58.5H x 41W x 84L
- 640F Full 58.5H x 56W x 84L
- 640Q Queen 58.5H x 63W x 87.5L
- 640K King 58.5H x 78.75W x 87.5L

Daybed (All Daybeds are Trundle Height)

- 640D Daybed 48H x 45W x 84L

Refer to Options Page

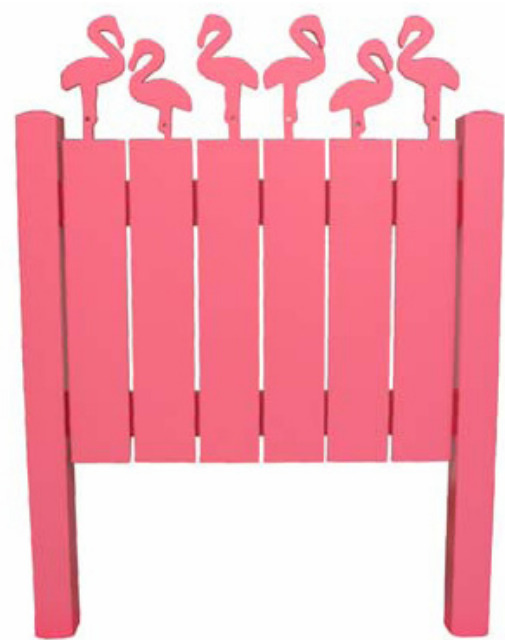

Item # 604TH
Flamingo Bed Twin Headboard
PHOTO *above* in Flamingo

Item # 604
Flamingo Bed

Complete with Headboard, Footboard, Slats & Rails

- 604T Twin 56.5.5H x 41W x 84L
- 604F Full 55.5H x 56W x 84L
- 604Q Queen 56.5H x 63W x 87.5L
- 604K King 56.5H x 78.75W x 87.5L

Daybed (All Daybeds are Trundle Height)

- 604D Daybed 48H x 45W x 84L

Refer to Options Page



www.seabrookclassics.com

www.coastalwoodcraft.com

Phone: 843.466.0241 Fax: 843.466.0288

By **Coastal Woodcraft**



Item # 614T
Oglethorpe Twin Bed
PHOTO *above* in Oyster

Item # 614
Oglethorpe Bed
Complete with Headboard, Footboard,
Slats & Rails

- 614T Twin 54H x 45.5W x 86.25
 - 614F Full 54H x 60.5W x 86.25L
 - 614Q Queen 54H x 67.5W x 88.25L
 - 614K King 58.5H x 83W x 88.25L
- Daybed (All Daybeds are Trundle Height)
- 640D Daybed

All Daybeds include Slats and
Plywood Bunkie Board
All Trundles sold separately



Item # 660D
Paddle Daybed
PHOTO *above* in Regatta over Tan
Bedding not included

Item # 660
Paddle bed
Complete with Headboard, Footboard,
Slats & Rails

- 660T Twin 41W x 84L
 - 6660F Full 56W x 84L
 - 660Q Queen 63W x 87.5L
 - 660K King 78.75W x 87.5L
- Daybed (All Daybeds are Trundle Height)
- 660D Daybed

All Daybeds include Slats and Plywood
Bunkie Board
All Trundles sold separately



www.seabrookclassics.com
www.coastalwoodcraft.com

Phone: 843.466.0241 Fax: 843.466.0288

By Coastal Woodcraft

Item # 645D
Crab Daybed
PHOTO *left* in Lobster Pot



Item # 645 (Above)
Crab Bed

Complete with Headboard, Footboard, Slats & Rails

- 645T Twin 57.5H x 41W x 84L
 - 645F Full 57.5H x 56W x 84L
 - 645Q Queen 57.5H x 63W x 87.5L
 - 645K King 57.5H x 78.75W x 87.5L
- Daybed (All Daybeds are Trundle Height)
- 645D Daybed 57.5H x 45W x 84L



Item # 61
Scroll Side Daybed
Daybed (All Daybeds are
Trundle Height)

- 611 Daybed 40.5H x
42.25W x 87.25

*See matching item # 611,
in Benches*

*See additional bed styles
with Plantation Shutters*



www.seabrookclassics.com
www.coastalwoodcraft.com

Phone: 843.466.0241 Fax: 843.466.0288

By Coastal Woodcraft



Item # 691T
Classic Bed Twin

PHOTO *above* in Victorian White over Sunset

Item # 691D
Classic Daybed

PHOTO *right* in St. Croix



Item # 691
Classic Bed

- French Trim Panel on Headboard & Footboard
- Appliqué on Headboard & Footboard

Complete with Headboard, Footboard, Slats & Rails

- 691T Twin 53H x 41W x 84L
- 691F Full 53H x 56W x 84L
- 691Q Queen 53H x 63W x 87.5L
- 691K King 53H x 78.75W x 87.5L
- 691D Daybed 47H x 45W x 84L



Item # 605T
Seaside Bed Twin

PHOTO *above* in Victorian White

Item # 605D
Seaside Daybed

PHOTO *right* in Victorian White over Bayside



Item # 605
Seaside Bed

- Scalloped Headboard & Footboard
- Complete with Headboard, Footboard, Slats & Rails

- 605T Twin 53H x 41W x 84L
- 605F Full 53H x 56W x 84L
- 605Q Queen 53H x 63W x 87.5
- 605K King 53H x 78.75W x 87.5L

Daybed (All Daybeds are Trundle Height)

- 605D Daybed 47H x 45W x 84L



www.seabrookclassics.com
www.coastalwoodcraft.com

Phone: 843.466.0241 Fax: 843.466.0288

By Coastal Woodcraft

Item # SL606
Straight Line Shutter Bed
(Standard Footboard for this item is
Low Profile Footboard # 650)

Complete with Headboard, Footboard,
Slats & Rails

- SL606T Twin 56H x 41W x 84L
 - SL606F Full 56H x 56W x 84L
 - SL606Q Queen 56H x 63W x 87.5L
 - SL606K King 56H x 78.75W x 87.5L
- Daybed (All Daybeds are Trundle Height)
- SL606D Daybed 47H x 45W x 84L

Refer to Options Page



Item # SL606TH
Shutter Bed
Twin Headboard
PHOTO *above* in
Weathered White



Item # 607Q
Plantation Bed Queen
PHOTO *above* in Victorian White over brown,
light rub

Item # 607D
Plantation DayBed
PHOTO *right* in Seabrook Black

Item # 607
Plantation Bed
Complete with Headboard, Footboard,
Slats & Rails

- 607T Twin 54H x 41W x 84L
 - 607F Full 54H x 56W x 84L
 - 607Q Queen 54H x 63W x 87.5L
 - 607K King 54H x 78.75W x 87.5L
- Daybed (All Daybeds are Trundle Height)
- 607D Daybed 47H @ Post Finial x 45W x 84L
50.5H @ Top of Arched Back



www.seabrookclassics.com
www.coastalwoodcraft.com

Phone: 843.466.0241 Fax: 843.466.0288

By **Coastal Woodcraft**

Item # 692F
Seabrook Shutter Bookcase Bed

Beadboard backing with 48" plantation shutter sides and one adjustable shelf. Height can be increased by extending legs at base, however shutters remain 48".

Priced complete with HB, FB, Rails and Slats

Item	Dimensions
• 692T	Twin 60H x 45W x 98L
• 692F	Full 60H x 60W x 98L
• 692Q	Queen 60H x 68W x 101.5L
• 692K	King 60H x 83.75W x 101.5L

Shown in Antique White over brown medium rub.



Item # 600A Faux Drawer Front Trundle (Above)

- Casters
 - False Drawer Front
 - Exterior: 12.5H x 75.5W x 40.75D
 - Interior: 11.75H x 74W x 38D
- (Fits a standard Trundle Mattress)
- Trundle rolls out



www.seabrookclassics.com
www.coastalwoodcraft.com

Phone: 843.466.0241 Fax: 843.466.0288

By **Coastal Woodcraft**



Item # 630
Hoppin ' John Bunkbed

- Fits Twin over Twin
- Beadboard Panels (other options available)
- Ladder
- 78.5H @ Ball Finial x 44.25D x 84L

PHOTO Left

- St. Croix

Shown with Item #600A (priced separately)

Also available in Twin over Full



Item # 631
Fish Bunkbed

- Fits Twin over Twin
- Fish Cutouts (other cutouts available)
- Ladder
- 78.5H @ Ball Finial x 44.25D x 84L

PHOTO Left

- Shown in Regatta

Also available in Twin over Full



www.seabrookclassics.com

www.coastalwoodcraft.com

Phone: 843.466.0241 Fax: 843.466.0288

By **Coastal Woodcraft**

Bookcases and Chests

<u>Item</u>	<u>Page #</u>
Item # 108 Sectional Bookcase	3
Item # 107 Small Sectional Bookcase	3
Item # 105 Plantation Shutter Bookcase	3
Item # 726 Seaside Bookcase	4
Item # 106 Two Piece Plantation Bookcase	4
Item # 117 One Piece Bermuda Bookcase	4
Item # 340 Large Arch Bookcase	5
Item # 341 Small Arch Bookcase	5
Item #307 Ashley River Cupboard	6
Item # 103 Bay Street Bookcase	7
Item # 340 - 700 Arched Bookcase/TV Cabinet	8



www.seabrookclassics.com

www.coastalwoodcraft.com

Phone: 843.466.0241 Fax: 843.466.0288

By **Coastal**  **Woodcraft**

Bookcases / Chests ... Page — 1



by **Coastal**  **Woodcraft**

Orders or Inquiries
843.466.0241

Fax
843.466.0288

Email
Info@seabrookclassics.com



www.seabrookclassics.com
www.coastalwoodcraft.com

Phone: 843.466.0241 Fax: 843.466.0288

By **Coastal**  **Woodcraft**

Bookcases / Chests ... Page — 2



Item # 108
Sectional Bookcase

- Five Adjustable Shelves
- Fluted Stiles
- Rosettes
- Beadboard Back
- 80H x 40W x 12D @ Crown
- Interior Depth: 10D

PHOTO *left* in Burgundy

Item # 107
Small Sectional Bookcase (Below)

- Three Adjustable Shelves
- Fluted Stiles
- Rosettes
- Beadboard Back
- 40.75H x 42W x 13D @ Crown
- Interior Depth: 10.75D

PHOTO *below* in Seabrook Black over Brown



Item # 105
Plantation Shutter Bookcase

- Arched Open Front
- Five Adjustable Shelves
 - Beadboard Back
 - Plantation Shutters each Side (functional)
 - 80.5H x 43W x 14.25D @ Crown

PHOTO *left*

- OPTIONAL Plantation Shutter Sides
- Victorian White Exterior
- Bayside Beadboard Back



www.seabrookclassics.com

www.coastalwoodcraft.com

Phone: 843.466.0241 Fax: 843.466.0288

By **Coastal Woodcraft**

Visit us at www.seabrookclassics.com

Item # 726
Seaside Bookcase

- Scalloped Top
- Three Adjustable Shelves
- Two Drawers
- Wood Knobs
- Barrel Feet
- 73.75H x 29.5W x 14.5D @ Crown
- Base 20D @Molding

PHOTO left in Weathered White



All Door Styles available, see Options.

Item # 106
Two Piece Plantation Bookcase

- Three Adjustable Shelves in Hutch @ 11.25D
- Two Doors
- Wood Knobs
- One Adjustable Shelf in Base
- Total Height: 80H
- Hutch Exterior: 46H x 44W x 16D @ Crown
- Base 21D @ Molding

PHOTO right

- Plantation Shutter Doors
- Exterior: Victorian White
- Beadboard Backing interior: Sunset

All Door Styles available, see Options.



Item # 117

One Piece Bermuda Bookcase

- Three Adjustable Shelves in Hutch
- Two Doors
- Wood Knobs
- 76H x 29.75W x 15.75D @ Crown
- Base 18D @ Molding

PHOTO left

- Bermuda Shutter Doors
- Exterior: Victorian White over Bayside
- Beadboard Backing interior: Bayside

All Door Styles available, see Options.



www.seabrookclassics.com
www.coastalwoodcraft.com

Phone: 843.466.0241 Fax: 843.466.0288

By **Coastal Woodcraft**

Bookcases / Chests ... Page — 4



Item # 340
Large Arch Bookcase

- One Fixed Shelf @ Top
- Two Adjustable Shelves
- Fluted Stiles
- Two Doors
- Wood Knobs
- 84H x 55W x 13.5D @ Crown
- Interior Depth: 10.75D

PHOTO Left

- Basket Weave Doors
- Exterior: Weathered White
- Beadboard Backing interior: Jambalaya

All Door Styles available, see Options.



Item # 341
Small Arch Bookcase

- One Fixed Shelf @ Top
- Two Adjustable Shelves
- Fluted Sides
- Two Doors
- Wood Knobs
- 84H x 45W x 13.5D @ Crown
- Interior Depth: 10.75D

PHOTO Right

- Flat Panel Doors
- Palm

All Door Styles available, see Options.



www.seabrookclassics.com

www.coastalwoodcraft.com

Phone: 843.466.0241 Fax: 843.466.0288

By **Coastal Woodcraft**



Item #307

Ashley River Cupboard

- Nine Adjustable Shelves in Open Hutch
- Three Drawers
- Six Doors
- Trimmed Side Panels
- Overall Dimensions 86H x 76.5W @ Crown
- Hutch 52H x 76.5W x 14.25D @ Crown.
- 10.50D Interior
- Base 34H x 74.5W x 22D @ Top.
- 20D Interior

PHOTO left

- Exterior: Oyster Roast over Palm.
- Interior Beadboard: Palm
- Flat Panel Doors

All Door Styles available, see Options



PHOTO left

- Exterior: Bermuda
- Interior Beadboard: Flamingo
- Flat Panel Doors

All Door Styles available, see Options



www.seabrookclassics.com

www.coastalwoodcraft.com

Phone: 843.466.0241 Fax: 843.466.0288

By **Coastal Woodcraft**



Item # 103
Bay Street Bookcase

- Three Piece Sectional
 - CENTER and SIDES
- Each Hutch: Arched
- One Fixed Shelf
 - Two Adjustable Shelves
- Each Base: Two Doors
- Overall Dimensions 85H x 132.5W @ Crown
 - Center Unit Hutch 57.5H x 53W x 13.5D @ Crown. 10.75D Interior
 - Center Unit Base 27.5H x 18D @ Top
 - Each Side Unit Hutch 82H x 41W x 11.5D @ Crown. 8.75D Interior
 - Each Side Unit Base 27.5H x 12.75D @ Top

PHOTO

- Seabrook Black over Natural
- Raised Panel Doors

All Door Styles available, see Options.



www.seabrookclassics.com

www.coastalwoodcraft.com

Phone: 843.466.0241 Fax: 843.466.0288

By **Coastal Woodcraft**

Page 47 of 138



Arched bookcase with TV Lift in DOWN position



Arched bookcase with TV Lift in UP position

Item # 340 - 700

Arched Bookcase/TV Cabinet

Shown with Level II Heavy Rubbed
finish in Seabrook Black over Natural

This is the arched bookcase, Item #340, modified to accept a plasma TV lift. All chests / wall units can be modified to accept a plasma TV lift.

Remote/Rocker switch controlled plasma TV lift for up to 42" TV,
with 220lb capacity.

Lift manufactured by Venset.

Also available for Plasma TV's up to 65" (contact us for quote)



www.seabrookclassics.com

www.coastalwoodcraft.com

Phone: 843.466.0241 Fax: 843.466.0288

By **Coastal Woodcraft**

Cabinets

<u>Item</u>	<u>Page #</u>
Base Options	2
Pocket and Wraparound Doors	3
Door Options	4
Item # 511 TV Stand	5
Item # 490 Beadboard Cookbook Cabinet	5
Item # 217 Cabinet	5
Item # 190 Tybee Cabinet	6
Item # 194 Tidewater Pie Safe	6
Item # 705 Three Drawer Linen Cabinet	7
Item # 701 Linen Closet	7
Item # 10750 Habersham Curio	8
Item # 25HC Lowcountry Jelly Cabinet	8
Item # 525 Small Linen Closet	9
Item # 524 Linen Chest	No Photo
Item # 745 Cottage Cocktail Cabinet	9
Item # 21HC Creekside Cabinet	10
Item # 24HC Carolina Corner Cupboard	10
Item # 113 Shellback Corner Cupboard	11
Item # 142 Corner Cupboard	11
Item #115 Corner Entertainment Center	12



www.seabrookclassics.com
www.coastalwoodcraft.com

Phone: 843.466.0241 Fax: 843.466.0288

By **Coastal**  **Woodcraft**

Base Options

4 Inch Barrel Feet



2 Inch Small Bun Feet



4 Inch Old South Turned Feet



3 inch Large Bun Feet



4 Inch High Bracket Feet

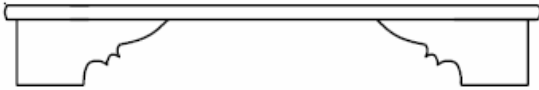

7 Inch High Tulip Feet



Seaside Base—*Height can vary*

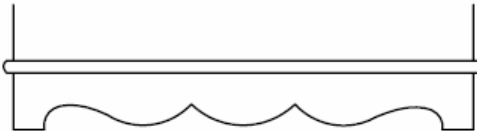

Straight Base—*Height can vary*



Charleston Bracket Feet with Routed Trim
Height can vary



Decorative Cut-out Base
Height can vary

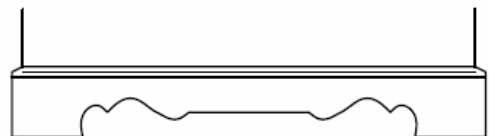

At times, the Seaside base, Bracket Feet, Charleston Bracket feet, and Decorative Cut-out bases may need to be modified slightly to accommodate the dimensions of the chest you desire. Should this substantially change the look of the piece, we will notify you prior to production.



www.seabrookclassics.com
www.coastalwoodcraft.com

Phone: 843.466.0241 Fax: 843.466.0288

By Coastal Woodcraft



PHOTO above
Pocket Doors Not Available with Plantation Shutters



PHOTO above
TV/VCR Swivel Stand
7.25H x 28W x 16D
DVD or VCR Area
4.25H x 21.25W x 14.5D



PHOTO above
Wrap Around Doors & TV/VCR Swivel Stand



NEW ITEM!
5 3/8 long stainless steel pulls available. \$8.00 per pull installed

PHOTO right
Center Unit with
Pocket Doors &
False Interior Wall
For Fixed or
Adjustable Shelves



www.seabrookclassics.com
www.coastalwoodcraft.com

Phone: 843.466.0241 Fax: 843.466.0288

By Coastal Woodcraft

Door Options

Door styles of Bermuda, Plantation, or Seagrass are an additional cost unless item is built with these doors identified as "Standard"

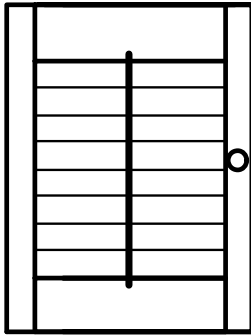

Plantation
Shutters

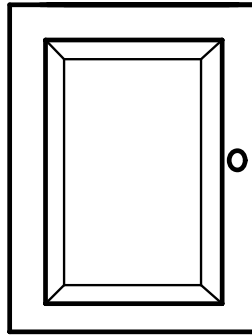

Raised Panel

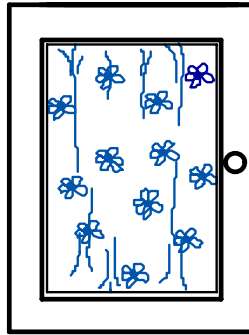

Fabric
(Customer provides fabric,
dowels provided)

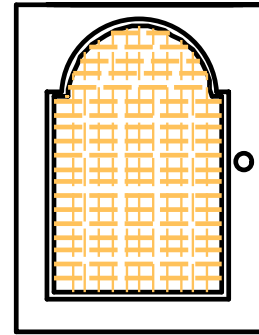

Arched
Seagrass
\$25 / door

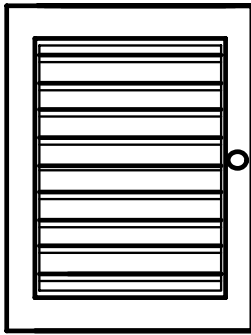

Bermuda
(fixed louvers)
\$35 / door

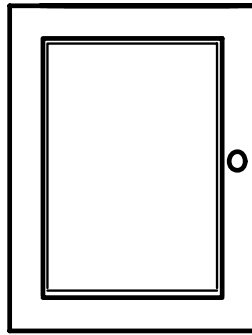

Flat panel

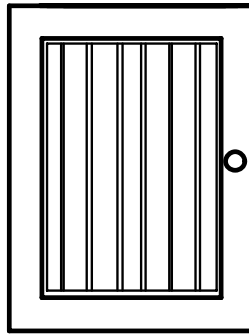

Squared
Bead board

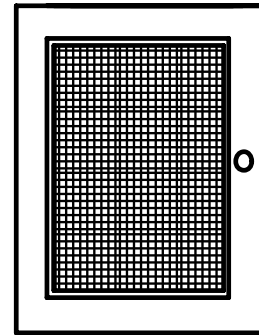

Carolina
Basket weave

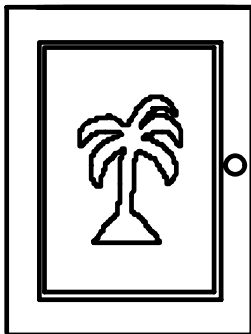

Palmetto
Cut out

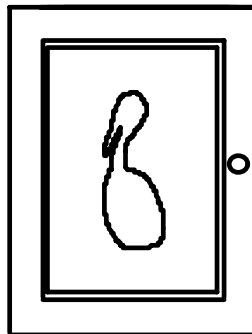

Pelican
Cut out

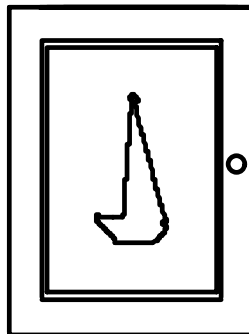

Sailboat
Cut out

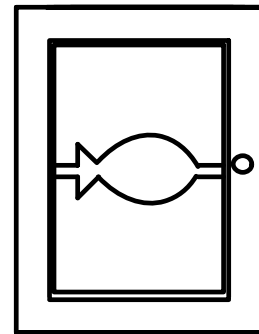

Fish
Cut out

Additional cut outs available : Whale on page 14 of Policies and Procedures section



www.seabrookclassics.com
www.coastalwoodcraft.com

Phone: 843.466.0241 Fax: 843.466.0288

By Coastal Woodcraft



**Item # 511
TV Stand**

- Two Doors
- Two Adjustable Shelves
- 30H x 38W x 22D @ Crown
- Inside Depth: 19.5D

PHOTO left

- Plantation Shutter Doors
- Victorian White

All Door Styles available, see Options



**Item # 490
Beadboard Cookbook Cabinet**

- Two Doors
- One Fixed Shelf
- 32.5H x 30W x 14.5D @ Crown
- Interior depth 12.25

PHOTO left

- Beadboard Doors
- Seabrook Yellow

All Door Styles available, see Options



**Item # 217
Cabinet**

- Two Drawers
- Two Doors
- Fluted Center Stile
- Arched Base
- 36H x 36W x 16D @ Crown
- Inside Depth: 13.25D

PHOTO left

- Flat Panel Doors
- Distressed Carolina Pine

All Door Styles available, see Options



www.seabrookclassics.com
www.coastalwoodcraft.com

Phone: 843.466.0241 Fax: 843.466.0288

By **Coastal Woodcraft**



Item # 190
Tybee Cabinet

- Two Pieces
- TOP: Two Doors
- BASE: One Drawer
- 58H x 27W x 20.25D @ Crown
- Interior 27.5H x 22W x 18D

PHOTO left

- Beadboard Doors
- Weathered White

All Door Styles available, see Options



Item # 194
Tidewater Pie Safe

- Two Doors
- Two Drawers
- Two Adjustable Shelves
- Turned Legs
- 58H x 34W x 15.5D @ Crown
- Interior Depth: 12.25

PHOTO left

- Open Panel Doors (Open Panel Doors come with Wooden Dowel Rods for fabric)
- Island Blue over Victorian White

All Door Styles available, see Options



www.seabrookclassics.com
www.coastalwoodcraft.com

Phone: 843.466.0241 Fax: 843.466.0288

By **Coastal Woodcraft**



Item # 705

Three Drawer Linen Cabinet

- Two Doors
- Three Drawers
- Three Adjustable Shelves
- 76H x 32W x 22D @ Crown
- Interior Depth: 19.25

PHOTO left

- Open Panel Doors (Open Panel Doors with wooden dowel rods)
Fabric is Customer's own Material
- Bermuda

PHOTO right

- OPTIONAL Wrap around Doors
- Bermuda Shutter Doors
- Wetlands Green

All Door Styles available, see Options



Item # 701

Linen Closet

- Two Doors
- TOP: Two Adjustable Shelves
- Fixed horizontal divider
- BOTTOM: One Adjustable Shelf
- 69H x 31.5W x 20D @ Crown
- Interior Depth: 17.5

PHOTO left & right

- Arched Open Panel Doors (Open)
- Panel Doors with wooden dowel rods. Fabric is Customer's Own Material
- OPTIONAL Hand Painted Bead Trim on Crown Molding in Seabrook Blue (priced separately)
- Antique White

All Door Styles available, see Options



www.seabrookclassics.com

www.coastalwoodcraft.com

Phone: 843.466.0241 Fax: 843.466.0288

By **Coastal Woodcraft**



Item # 10750
Habersham Curio

- 3 glass shelves
- 2 drawers
- Savannah Clapboard backing
- Dimensions: 63H x 37.7W x 13.5D @ Crown
- Interior Depth: 10.5

Shown in Shrimp-n-Grits

Glass shipped separately.

Dimensions can easily be modified to accommodate needs.



Item # 25HC
Lowcountry Jelly Cabinet

- Six Adjustable Shelves
- 68H x 39W x 11.5D @ Crown
- Interior Depth: 9.0

PHOTO *left*

- Gullah over Victorian White
- Plantation Shutter Doors

All Door Styles available, see Options



Carolina Lowcountry
COLLECTION™



www.seabrookclassics.com
www.coastalwoodcraft.com

Phone: 843.466.0241 Fax: 843.466.0288

By **Coastal Woodcraft**



Item # 525
Small Linen Closet

- One Door
- Two Drawers
- Three Adjustable shelves
- Decorative Cut-out Base
- 64H x 26.25W x 14.25D @ Crown
- Interior: 35H x 18.25W x 11.5D

PHOTO left & right

- OPTIONAL Plantation ShutterDoor
- Wetlands Green

All Door Styles available, see Options



Similar to item above

Item # 524
Linen Chest *Not shown*

- One Door
- Two Drawers
- Three Adjustable Shelves
- Straight Base
- 76H x 26.25W x 21D @ Crown
- Interior Depth: 18.25D



Item # 745
Cottage Cocktail Cabinet

- Two Doors
 - Three Drawers
 - Pull-out Shelf
 - Interior Curved Shelf
 - 62H x 30.25W x 21.25D @ Crown
- Interior Dimensions Below Curved Shelf :17H x 26.25W x 18.5D

PHOTO left & right

- Plantation Shutter Doors
- Wrap-around Doors
- Wetlands Green over Seabrook Black

All Door Styles available, see Options



www.seabrookclassics.com
www.coastalwoodcraft.com

Phone: 843.466.0241 Fax: 843.466.0288

By **Coastal Woodcraft**



**Item # 21HC
Creekside Cabinet**

- Two Adjustable Shelves above
- One Adjustable Shelf below
- Barrel Feet
- Single Drawer on glides
- 80H x 35W x 14.5D @ Crown
- Interior Depth 12.0

PHOTO left

- Flat Panel Doors above and Beadboard Doors below in Oyster

All Door Styles available, see Options



**Item 24HC
Carolina Corner Cupboard**

- Fixed horizontal divider
- 2 Adjustable shelves above
- 1 Adjustable shelf below
- 82H x 45W @ Crown 28.5 Corner Out
- Interior depth of shelf at center line 16.0
- Arched Flat Panel Doors

PHOTO left

- Oyster Roast
- Flat Panel Doors

All Door Styles available, see Options



www.seabrookclassics.com
www.coastalwoodcraft.com

Phone: 843.466.0241 Fax: 843.466.0288

By **Coastal Woodcraft**

Page 58 of 138



Item # 113
Shellback Corner Cupboard

Adjustable Shelves Not Available

- Three Fixed Shelves
- Two Doors
- Beadboard Backing interior
- 86H x 38W x 26 Corner Depth
- Interior depth at center line 11.25

PHOTO Left

- Flat Panel Doors
- OPTIONAL Brass Handles
- Exterior: Oyster
- Interior Backing and Shelves Shown in Seabrook Yellow

All Door Styles available, see Options

Item # 142
Corner Cupboard

Adjustable Shelves Not Available

- Two Fixed Shelves
- One Door
- Wood Knob
- Beadboard Backing Interior
- 88H x 38W x 24 Corner Depth
- Interior depth at center line 13.5

PHOTO Right

- Flat Panel Door
- Antique White over Brown

All Door Styles available, see Options



www.seabrookclassics.com
www.coastalwoodcraft.com

Phone: 843.466.0241 Fax: 843.466.0288

By **Coastal Woodcraft**



ITEM #115
CORNER ENTERTAINMENT CENTER

- Four Doors
- Fixed horizontal shelf divider
- Decorative Cut-out Base
- 86H x 56W x 41 Corner Depth
- Interior TOP: 39.25H x 36W x 24D to Flat Back
- Interior BOTTOM: 28.5H x 32.5W x 24D to Flat Back
- Depth at Edge of Door Opening: 14.25D

PHOTO

- Raised Panel Doors
- OPTIONAL TV/VCR Swivel Stand
- Flamingo over Victorian White

All Door Styles available, see Options

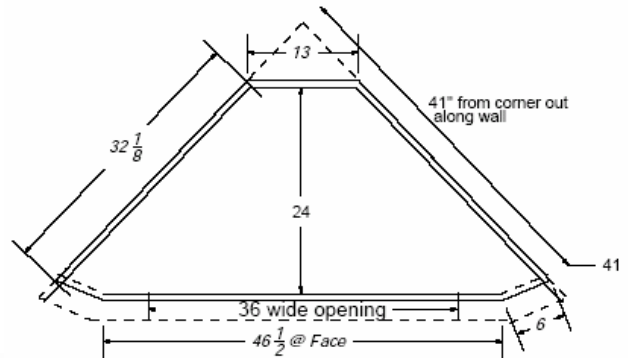

www.seabrookclassics.com
www.coastalwoodcraft.com

Phone: 843.466.0241 Fax: 843.466.0288

By Coastal Woodcraft

Chairs

<u>Item</u>	<u>Page #</u>
Item # 265 Mission Side Chair 2
Item # 265A Mission Arm Chair 2—Not Shown
Item # 265-24B Mission Bar Stool @ 24H 2
Item # 265-30B Mission Bar Stool @ 30H 2
Item # 1203 Empire Side Chair 2
Item # 1203AB Empire Arm Chair 2
Item # S-122 Empire Bar Stool @ 24H 2—Not Shown
Item # S-123 Empire Bar Stool @ 30H 2—Not Shown
Item # 801 Magnolia Bench 3
Item # 217B Maine Ladderback Side Chair 3
Item # 217AB Maine Ladderback Arm Chair 3—Not Shown
Item # 1602 Tradd Side Chair 3
Item # 1622 Tradd Arm Chair 3 – Not Shown
Item # C20 Double X Back Side Chair 4
Item # S-202 Double X Back Bar Stool @ 24H 4—Not shown
Item # S-203 Double X Back Bar Stool @ 30H 4
Item # C10 Single X Back Side Chair 4



www.seabrookclassics.com
www.coastalwoodcraft.com

Phone: 843.466.0241 Fax: 843.466.0288

By **Coastal**  **Woodcraft**



**Item # 265
Mission Side Chair**

- Wood Seat
- Seat 18H x 18W x 16D
- Back 39.25H x 17W

PHOTO left

- Seabrook Blue Item

265A Mission Arm Chair

- *Not shown*

**Item # 265-24B
Mission Bar Stool @ 24H**

PHOTO upper right

- *Sailing*

**Item # 265-30B
Mission Bar Stool @ 30H**

PHOTO right

- Bayside



Item # 1203 Empire Side Chair
Replaces Item # 1200

- Rush Seat
- Seat 17.5H x 18W x 17D
- Back 38.5H x 18.75W

PHOTO left

- Antique White

**Item # 1203AB
Empire Arm Chair**

PHOTO right

- Hibiscus

**Item # S-122
Empire Bar Stool @ 24H**

- *Not shown*

**Item # S-123
Empire Bar Stool @ 30H**

- *Not shown*



www.seabrookclassics.com

www.coastalwoodcraft.com

Phone: 843.466.0241 Fax: 843.466.0288

By **Coastal Woodcraft**



**Item # 801
Magnolia Bench**

- Curved Legs
- 19.5H including Cushion.
- Frame is 17W squared.
- Legs are 18.5W at floor
- Muslin Cushion seat is standard

PHOTO left

- Antique White

Magnolia Bench may be covered with customers own material for an additional charge, please see price list.



**Item # 217B
Maine Ladderback Side Chair**

- Muslin Cushion seat is standard
- Seat 18.5H x 20W x 19D
- Back 41.75H x 17.5W

PHOTO left

- Seabrook Red

**Item # 217AB
Maine Ladderback Arm Chair**

- *Not shown*

Maine Ladderback Chair may be covered with customers own material for an additional charge, please see price list.



**Item # 1602
Tradd Side Chair**

- Wooden Seat
- Steam bent contoured back
- Dimensions at seat 18H x 20.25W x 18.5D
- Overall Dimensions 43H x 23.5D

PHOTO left

- Seabrook Green over Seabrook Yellow

**Item # 1622
Tradd Arm Chair**

- *Not shown*



www.seabrookclassics.com

www.coastalwoodcraft.com

Phone: 843.466.0241 Fax: 843.466.0288

By **Coastal Woodcraft**



Item # C20
Double X Back Side Chair

- Wood Seat
- Seat 17H x 19.75W x 17.5D
- Back 41.5H x 19.25W

PHOTO left

- Margarita



Item # S-202
Double X Back Bar Stool @ 24H

- *Not shown*

Item # S-203
Double X Back Bar Stool @ 30H
PHOTO right

- Seabrook Red



Item # C10
Single X Back Side Chair

- Wood Seat
- Seat 17.5H x 18.75W x 15.25D
- Back 36H x 17W

PHOTO

- Oyster



www.seabrookclassics.com

www.coastalwoodcraft.com

Phone: 843.466.0241 Fax: 843.466.0288

By **Coastal Woodcraft**

Chest of Drawers

<u>Item</u>	<u>Page #</u>
Base Options	2
Handle and Drawer Options	3
Item # 725 Seaside Chest of Drawers	4
Item # 111 Four Drawer Chest	4
Item # 110 Basket Weave Chest	4
Item # 435 Sullivan Chest	5
Item # 301 French Chest	5
Item # 310 Cottage Chest	5
Item # 112 Three Drawer Chest	6
Item # 23HC Lowcountry Bedside Chest of Drawers	6
Item # 27HC Lowcountry Riverside Chest of Drawers	6
Item # 578 Classic Seven Drawer Chest	7
Item # 577 Plantation Chest of Drawers	7
Item # 577 Plantation Chest of Drawers	7
Item # 125 Five Drawer Chest	8
Item # 735 Cooper River Chest	8
Item # 730 Edisto Chest	8
Item # 118 Cottage Chiffonier	9
Item # 521 Lingerie Chest	9
Item # 537 Dockside Blanket Chest	10
Item # 119 Dockside Chest	10
Item # 714 Oglethorpe Chest	10
Item # 591 Leslie's Chest of Drawers	11



www.seabrookclassics.com

www.coastalwoodcraft.com

Phone: 843.466.0241 Fax: 843.466.0288

By **Coastal**  **Woodcraft**

Base Options

4 Inch Barrel Feet



2 Inch Small Bun Feet



4 Inch Old South Turned Feet



3 inch Large Bun Feet



4 Inch High Bracket Feet



7 Inch High Tulip Feet



Seaside Base—*Height can vary*



Straight Base—*Height can vary*



Charleston Bracket Feet with Routed Trim
Height can vary



Decorative Cut-out Base
Height can vary

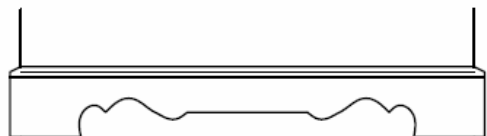

At times, the Seaside base, Bracket Feet, Charleston Bracket feet, and Decorative Cut-out bases may need to be modified slightly to accommodate the dimensions of the chest you desire. Should this substantially change the look of the piece, we will notify you prior to production.



www.seabrookclassics.com
www.coastalwoodcraft.com

Phone: 843.466.0241 Fax: 843.466.0288

By Coastal Woodcraft

Handle and Drawer Options

(all items come *standard with Wood knobs*)



Bail Pulls



Brass Handle



NEW ITEM!

5 3/8 long stainless steel pulls available. \$8.00 per pull installed

Original
FULL LENGTH
drawers



Split
Drawer
option



www.seabrookclassics.com
www.coastalwoodcraft.com

Phone: 843.466.0241 Fax: 843.466.0288

By **Coastal Woodcraft**



Item # 725
Seaside Chest of Drawers

- Three Drawers
- Wood Knobs
- Seaside Base
- 33H x 36W x 20D @ Top

PHOTO *left*

- Beach

Refer to Options Page



Item # 111
Four Drawer Chest

- Four Drawers
- Wood Knobs
- Bracket Feet
- 35H x 45W x 2D @ Top

PHOTO *left*

- Antique White

Refer to Options Page



Item # 110
Basket Weave Chest

- 11 Drawers
- Tulip Feet
- 45.75H x 65W x 18D @ Top

PHOTO *left*

- Seabrook Black

*Similar items are
122 Basket Weave Nightstand,
670 Basket Weave Bed*

Refer to Options Page



www.seabrookclassics.com

www.coastalwoodcraft.com

Phone: 843.466.0241 Fax: 843.466.0288

By Coastal  Woodcraft



Item # 435
Sullivan Chest

- 2 Drawers with French Trim
- Wood Knobs
- French Legs
- 36.5H x 48W x 20.5D @ Top

PHOTO left

- Oyster

Refer to Options Page



Item # 301
French Chest

- Three Drawers with Quarter Round Bead Trim
- Wood Knobs
- French Legs
- 36.5H x 48W x 16D @ Top

PHOTO left

- Seabrook Yellow

Refer to Options Page



Item # 310
Cottage Chest

- Four Drawers with Quarter Round Bead Trim
- Wood Knobs
- French Legs
- Curved Skirt
- 40H x 52W x 20.5D @ Top

PHOTO left

- St. Croix

Refer to Options Page



www.seabrookclassics.com

www.coastalwoodcraft.com

Phone: 843.466.0241 Fax: 843.466.0288

By **Coastal Woodcraft**



Item # 112
Three Drawer Chest

- Quarter Round Bead Trim on Three Drawers
- Wood Knobs
- Bracket Feet
- 33H x 36W x 20D @ Top

PHOTO left

- Antique White over Seabrook Blue

Refer to Options Page



Item # 23HC
Lowcountry Bedside Chest of Drawers

- French Trim on Four Drawers
- Wood knobs
- Charleston Bracket Feet
- Recessed Side Panels
- 30.5H x 26W x 19D @ Top

PHOTO left

- Ricefield over Sunset

Refer to Options Page



Item # 27HC
Lowcountry Riverside Chest of Drawers

- French Trim on Four Drawers
- Wood Knobs
- Charleston Bracket Feet
- Recessed Side panels
- 40H x 36W x 21D @ Top

PHOTO left

- Camellia over Oyster
- OPTIONAL Monogram (priced separately)

Monogram

(See Monogram Options)

- Style: Vine
- Oyster

Refer to Options and Monograms Page



www.seabrookclassics.com
www.coastalwoodcraft.com

Phone: 843.466.0241 Fax: 843.466.0288

By **Coastal Woodcraft**



Item # 578
Classic Seven Drawer Chest

- Seven Drawers
- French Trim
- Appliqué
- Wood Knobs
- 36H x 62.5W x 21D @ Top

PHOTO *left*

- Beach

Refer to Options Page



Item # 577
Plantation Chest of Drawers

- Five Drawers
- Two Doors
- Wood Knobs
- One adjustable shelf each in side compartment
- 36H x 56W x 22D @ Top

PHOTO *left*

- Victorian White
- Plantation Shutter Doors

All Door Styles available, see Options



Item # 577
Plantation Chest of Drawers
(Same item as above)

PHOTO *left*

- Bayside
- Boat Cut-Out Door

All Door Styles available, see Options



www.seabrookclassics.com
www.coastalwoodcraft.com

Phone: 843.466.0241 Fax: 843.466.0288

By Coastal Woodcraft



Item # 125
Five Drawer Chest

- Five Drawers
- Wood Knobs
- Bracket Feet
- 41.5H x 36W x 18D @ Top

PHOTO left

- Victorian White

Refer to Options Page



Item # 735
Cooper River Chest

- Two Piece Chest
- Six Drawers
- 48H overall @ Top
- Top is 15H x 32.5W x 19D
- Base is 33H x 34W x 19.75D
- Ogee Style Feet

PHOTO left

- Antique White



Item # 730
Edisto Chest

- Two Pieces
- Eight Drawers
- Wood Knobs
- Arched Base
- 53H x 39W x 22D @ Top

PHOTO left

Regatta over Victorian White

SMALL PHOTO left

- OPTIONAL Bail Handles
- Gullah Blue

Refer to Options Page



www.seabrookclassics.com
www.coastalwoodcraft.com

Phone: 843.466.0241 Fax: 843.466.0288

By **Coastal Woodcraft**



Item # 118
Cottage Chiffonier

- Quarter Round Bead Trim on 5 Drawers
- French Curved Legs
- 60H x 30.5W x 16D @ Top

PHOTO left

- Oyster over Wisteria

Similar items are:

- # 135 Cottage Nightstand,*
- # 301 French Chest*
- # 310 Cottage Chest*



Item # 521
Lingerie Chest

- Two Doors
- Six Drawers
- One Adjustable Shelf
- Small Bun Feet
- 80H x 28.5W x 18D @ Crown

PHOTO left closed, right open.

- Plantation Shutter Doors
- Bermuda over St. Croix

All Door Styles available,
see Options



www.seabrookclassics.com
www.coastalwoodcraft.com

Phone: 843.466.0241 Fax: 843.466.0288

By **Coastal Woodcraft**



**Item # 537
Docksider Blanket Chest**

- Hinged Top lifts to provide wide storage
- Rope Trim and Flat Panels at front and sides.
- Old South Turned Feet
- 19H x 40W x 18D @ Top

PHOTO left

- Victorian White
- OPTIONAL Monogram (priced separately)

Monogram

(See Monogram Options)

- Style: Vine
- Island Blue



**Item # 119
Docksider Chest**

- Rope Trim
- Framed Flat Panel on Sides
- Five Drawers with English Bead Trim
- Old South Turned Feet
- 40.5H x 40.5W x 21.25D @ Top

PHOTO left

- Seabrook Black over Brown

Refer to Options Page



**Item # 714
Oglethorpe Chest**

- Double Crown Top
- 5 Drawers (Top drawers are split)
- Step out Stiles
- Oglethorpe Feet
- 42H x 54W x 19.5D @ Top

PHOTO left

- Regatta

Refer to Options Page



www.seabrookclassics.com
www.coastalwoodcraft.com

Phone: 843.466.0241 Fax: 843.466.0288

By **Coastal Woodcraft**

Visit us at www.seabrookclassics.com



Item # 591
Leslie's Chest of Drawers

- 8 drawers, bead board bottoms
- Large bun feet
- Beadboard panel sides
- Beadboard squared panel doors
- Standard wood knobs
- 61.5W x 21D x 36.5H

Photo left shown open, below with doors closed.

- Shown in Victorian white over Camellia, in medium rub

All Door Options Available



www.seabrookclassics.com
www.coastalwoodcraft.com

Phone: 843.466.0241 Fax: 843.466.0288

By Coastal  Woodcraft

Page 75 of 138



by **Coastal**  **Woodcraft**

Orders or Inquiries
843.466.0241

Fax
843.466.0288

Email
Info@seabrookclassics.com



www.seabrookclassics.com
www.coastalwoodcraft.com

Phone: 843.466.0241 Fax: 843.466.0288

By **Coastal**  **Woodcraft**

Chest of Drawers ... Page — 12

Desks and Office

<u>Item</u>	<u>Page #</u>
Desk, Handle, and Base Options for Desks	2
Item # 123 Texas Writing Desk	3
Item # 336 Farm Style Desk	3
Item # 124 Small Desk or Dressing Table	3
Item # 522 Salt Marsh Secretary	4
Item # 492 Brewton File Cabinet	4
Item # 739 Palmetto Computer Cabinet	5
Item # 538 Plantation Computer Desk	5
Item # 127H Optional Hutch for Item # 127	6
Item # 127 Pedestal Desk	6
Item # 333 Savannah Dressing Table	6
Item # 335 Computer Desk with Turned Legs	7
Item # 335H Optional Hutch for Item # 335	7
Item # 766 Plantation Desk	7
Item # 777 Planters Desk	8
Item # 755 Island Corner Desk	9
Item # 742 Middleton Creek Desk	9



www.seabrookclassics.com

www.coastalwoodcraft.com

Phone: 843.466.0241 Fax: 843.466.0288

By **Coastal**  **Woodcraft**

Desks and Office ... Page — 1

Desk Options

Many of our desk and office items can be modified by changing the base, drawer face, or doors where applicable. Please specify your choices when ordering.

Handle Options

All items come standard with painted wood knobs. We provide 2 alternative handle/pulls. See price list for these options. Items can be built with holes drilled and now hardware if the client is to provide hardware at the end delivery point. Also, if a client desires a specific handle or pull, you can send them to us and we will attach them at no cost.



NEW ITEM!
5 3/8 long stainless steel pulls.

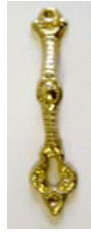

Brass Handles



Bail Pulls

Base Options



3 INCH HIGH LARGE BUN FEET



7 INCH HIGH TULIP FEET



4 INCH HIGH BARREL FEET

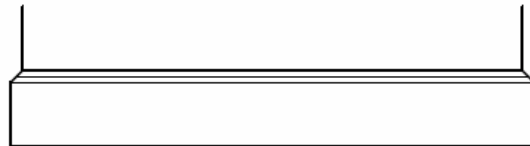

STRAIGHT BASE
(HEIGHT CAN VARY)



www.seabrookclassics.com
www.coastalwoodcraft.com

Phone: 843.466.0241 Fax: 843.466.0288

By **Coastal Woodcraft**



Item # 123
Texas Writing Desk

- One Drawer
 - Cabriole Legs
 - 31H x 43W x 24D @ Top
- PHOTO left**
- Victorian White

Item # 336
Farm Style Desk

- Pull-out Keyboard Tray
- Farm Style Legs
- 30H x 50W x 25D @ Top

PHOTO right

- OPTIONAL Sealed English on White Pine Top
- Seabrook Black Base

Refer to Options Page
Available with Pencil Drawer



Item # 124
Small Desk or Dressing Table

- Three drawers
- 30.5H x 48W x 19D @ Top

PHOTO left

- OPTIONAL Sealed English on White Pine Top
- Coastal Base

Item # 1203
Empire Side Chair
(See Chairs)

- Coastal



www.seabrookclassics.com
www.coastalwoodcraft.com

Phone: 843.466.0241 Fax: 843.466.0288

By **Coastal Woodcraft**



**Item # 522
Salt Marsh Secretary**

- Two Doors
- One Adjustable Shelf in Top Compartment
- Fold Down Desk Top
- Three Drawers
- Bun Feet
- 73.75H x 30.5W x 10.75D @ Crown

PHOTO left

- Plantation Shutter Doors
- Seabrook Yellow

All Door Styles available, see Options

**Item # 492
Brewton File Cabinet**

- 3 Files Drawers for both Standard and Legal
- Drawer Trim is English Bead
- Inverted Route on Top
- 42H x 25W x 24D @ Top

PHOTO right

- Island Blue



www.seabrookclassics.com

www.coastalwoodcraft.com

Phone: 843.466.0241 Fax: 843.466.0288

By **Coastal Woodcraft**

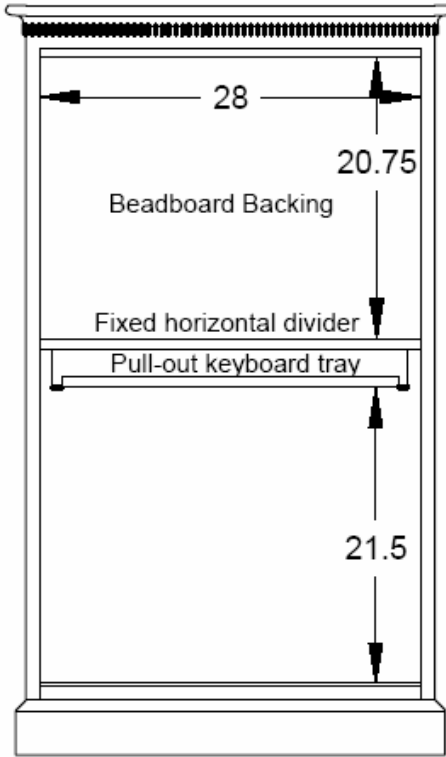

**Item # 739
Palmetto Computer Cabinet**

- Two Doors
- One Fixed Shelf
- Pull-out Keyboard Tray
- 55H x 32.5W x 22.75 @ Crown
- Interior: 46.75W x 20D

PHOTO left

- Regatta
- Seagrass Doors
- OPTIONAL Wrap-Around Doors

*All Door Styles available,
see Options*

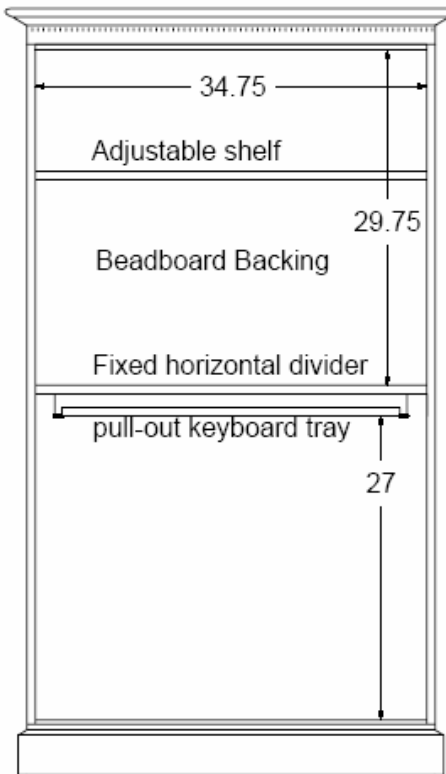

**Item # 538
Plantation Computer Desk**

- Two Doors
- One Adjustable Shelf
- One Fixed Shelf
- Pull-out Keyboard Tray
- 68H x 39W x 26D @ Crown

PHOTO left

- Plantation Shutter Doors
- Victorian White over Seabrook Blue

*All Door Styles available,
see Options*



www.seabrookclassics.com
www.coastalwoodcraft.com

Phone: 843.466.0241 Fax: 843.466.0288

By Coastal Woodcraft

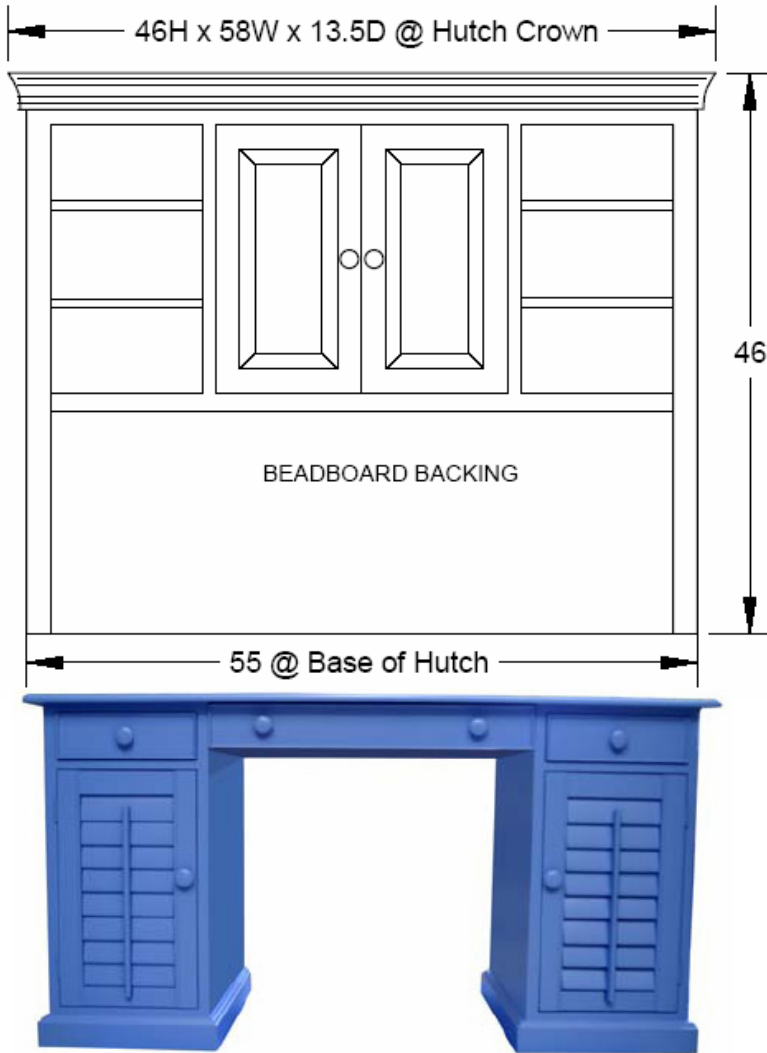

Item # 127H
Optional Hutch for Item # 127

LINE DRAWING left

- Shown in line drawing
- 2 Adjustable Shelves each side
- 1 Set of Doors

All Door Styles available, see Options

Item # 127
Pedestal Desk

- Three Drawers
- Two Doors
- One Adjustable Shelf each Side Compartment

• Furniture Finish All Sides
• 30H x 57.5W x 25D @ Top

PHOTO left

- Plantation Shutter Doors
- Bayside
- Available with Pull-out Keyboard Tray

All Door Styles available, see Options

Item # 333
Savannah Dressing Table

- Three Drawers
- Two Doors
- One Adjustable Shelf each side
- Furniture Finish All Sides
- 30H x 46W x 17.25D @ Top

PHOTO right

- Open Panel Doors (Open Panel Doors, include wooden dowel rods for Fabric. (Fabric C.O.M.)
- Victorian White over Seabrook Yellow
- Shown with Item # 801 Magnolia Bench

All Door Styles available, see Options



Item # 801
Magnolia Bench

- See Chairs



www.seabrookclassics.com
www.coastalwoodcraft.com

Phone: 843.466.0241 Fax: 843.466.0288

By **Coastal Woodcraft**



Item # 335
Computer Desk with Turned Legs

- Keyboard Pull-out Tray
- One Drawer
- One File Drawer
- Holds Standard Letter Files
- Turned Legs
- Furniture Finish All Sides
- 30H x 48W x 25D @ Top

PHOTO left

- Seabrook Red

Available with Pencil Drawer



Item # 335H
Optional Hutch for Item # 335

- Beadboard Backing
- One Door
- Two Adjustable Shelves
- 40H x 49W x 13.5D @ Crown

PHOTO left

- Brown over Carolina Khaki
- Squared Seagrass Door

All Door Styles available, see Options



Item # 766
Plantation Desk

- One Door
- Two Adjustable Shelves
- Three Drawers
- Pull-out Keyboard Tray
- Hutch: 40H x 52W x 13.75D
- Desk: 30H x 52.5W x 26D
- Total Height: 70H

PHOTO left

- Plantation Shutter Door
- Seabrook Green over Victorian White
- Available with Pencil Drawer

All Door Styles available, see Options



www.seabrookclassics.com

www.coastalwoodcraft.com

Phone: 843.466.0241 Fax: 843.466.0288

By **Coastal Woodcraft**



**Item # 777
Planters Desk**

Hutch contains set of Doors

- Two Adjustable Shelves each side
- Beadboard Backing
- Hutch: 52H x 73W x 14D

Base contains

- Keyboard Pull-out Tray
- Two Drawers
- Two File Drawers (Standard Letter Files)
- Turned Legs
- Base: 30H x 75W x 26D
- Total Height: 82H

PHOTO *above*

- Plantation Shutter Doors
- Victorian White
- Available with Pencil Drawer

All Door Styles available, see Options



www.seabrookclassics.com
www.coastalwoodcraft.com

Phone: 843.466.0241 Fax: 843.466.0288

By **Coastal**  **Woodcraft**

Page 84 of 138



**Item # 755
Island Corner Desk**

- Hutch contains two Shelves in each Arch. (One Fixed, one Adjustable.)

Base contains Four Drawers

- Keyboard Pull-out Tray w/o File Drawers
- 82H x 64.25W Corner Out Along Wall at Desk Top

PHOTO

- Weathered White

Optional Pencil Drawer available



**Item # 742
Middleton Creek Desk**

- Hutch contains two Shelves in each Arch. (One Fixed, one Adjustable.)

Base contains Four Drawers

- Keyboard Pull-out Tray
- Two File Drawers
- Two Piece Overall Dimensions 82H x 82.5W @ Crown
- Hutch 52H x 82.5W x 14.25D @ Crown. 10.5D Interior
- Base 30H x 80W x 22.75D @ Desk Top

PHOTO

- Weathered White

Optional Pencil Drawer available



www.seabrookclassics.com

www.coastalwoodcraft.com

Phone: 843.466.0241 Fax: 843.466.0288

By **Coastal Woodcraft**

Page 85 of 138



by **Coastal**  **Woodcraft**

Orders or Inquiries
843.466.0241

Fax
843.466.0288

Email
Info@seabrookclassics.com



www.seabrookclassics.com
www.coastalwoodcraft.com

Phone: 843.466.0241 Fax: 843.466.0288

By **Coastal**  **Woodcraft**

Desks and Office ... Page — 10

Entertainment Centers

<u>Item</u>	<u>Page #</u>
Base Options, Door Configuration Options	2-3
Item # 302 Large Arch Entertainment Center	4
Item # 523 Plantation Entertainment Center	5
Item # 101 Entertainment Center	5
Item # 100 Entertainment Center	5
Item # 97 English Armoire	6
Item # 96 Island Armoire	6
Item # 180 Half Entertainment Center	7
Item # 531 Plantation Half Entertainment Center	7
Item # 542 Plantation Entertainment Center	8
Item # 539 Plantation Medium Entertainment Center	9
Item # CG530 Plantation Entertainment Center	10
Item # 340 - 700 Arched Bookcase/TV Cabinet	11
Item # 536 Plantation Linen Press	12



www.seabrookclassics.com

www.coastalwoodcraft.com

Phone: 843.466.0241 Fax: 843.466.0288

By **Coastal**  **Woodcraft**

Entertainment Centers ... Page — 1

Base Options

4 Inch Barrel Feet



2 Inch Small Bun Feet



4 Inch Old South Turned Feet



3 inch Large Bun Feet



4 Inch High Bracket Feet



7 Inch High Tulip Feet



Seaside Base—*Height can vary*

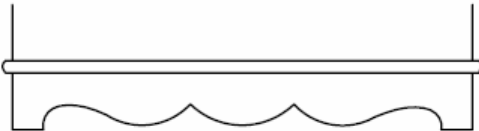

Straight Base—*Height can vary*



Charleston Bracket Feet with Routed Trim
Height can vary



Decorative Cut-out Base
Height can vary

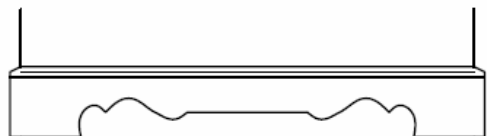

At times, the Seaside base, Bracket Feet, Charleston Bracket feet, and Decorative Cut-out bases may need to be modified slightly to accommodate the dimensions of the chest you desire. Should this substantially change the look of the piece, we will notify you prior to production.



www.seabrookclassics.com
www.coastalwoodcraft.com

Phone: 843.466.0241 Fax: 843.466.0288

By Coastal Woodcraft

Entertainment Centers ... Page — 2

Door Configuration Options



PHOTO *above*
Pocket Doors Not Available with Plantation Shutters



PHOTO *above*
TV/VCR Swivel Stand
7.25H x 28W x 16D
DVD or VCR Area
4.25H x 21.25W x 14.5D



PHOTO *above*
Wrap Around Doors & TV/VCR Swivel Stand

PHOTO *right*
Center Unit with
Pocket Doors &
False Interior Wall
For Fixed or
Adjustable Shelves



www.seabrookclassics.com
www.coastalwoodcraft.com

Phone: 843.466.0241 Fax: 843.466.0288

By Coastal Woodcraft

Entertainment Centers ... Page — 3



Item # 302
Large Arch Entertainment Center
Only Available with Pocket Doors

- Four Doors
- One fixed horizontal shelf divider
- 86H x 60.75W x 29D @ Crown
- Exterior: 86H x 55.75W x 26.5D
- Interior: 45.75H x 43W x 22.75D

PHOTO

- Weathered White with Medium Rub

Available in all Door Styles
(except Plantation Shutters)
See Options



www.seabrookclassics.com
www.coastalwoodcraft.com

Phone: 843.466.0241 Fax: 843.466.0288

By **Coastal**  **Woodcraft**

Entertainment Centers ... Page — 4



Item # 523
Plantation Entertainment Center
Two Drawers

- Two Doors
- Two Drawers
- 80H x 42.5W x 25.75D @ Crown
- Interior: 47.75H x 36W x 22.5D

PHOTO left

- Plantation Shutter Doors
- Carolina Khaki

All Door Styles available, see Options



Item # 101
Entertainment Center

- 76H x 39.5W x 24.75D @ Crown
- Exterior: 76H x 36W x 23D
- Interior Depth: 22D

PHOTO right

- Raised Panel Doors
- Seabrook Red

All Door Styles available, see Options



Item # 100
Entertainment Center

- Four Doors
- Dentil Molding
- Fixed horizontal divider
- Decorative Cut-out Base
- 86H x 51.5W x 25.25D @ Crown
- Exterior: 86H x 48W x 23.5D
- Interior Depth: 22D

PHOTO left

- Raised Panel Doors
- OPTIONAL Wrap-around Doors
- Victorian White



www.seabrookclassics.com
www.coastalwoodcraft.com

Phone: 843.466.0241 Fax: 843.466.0288

By **Coastal Woodcraft**

Entertainment Centers ... Page — 5

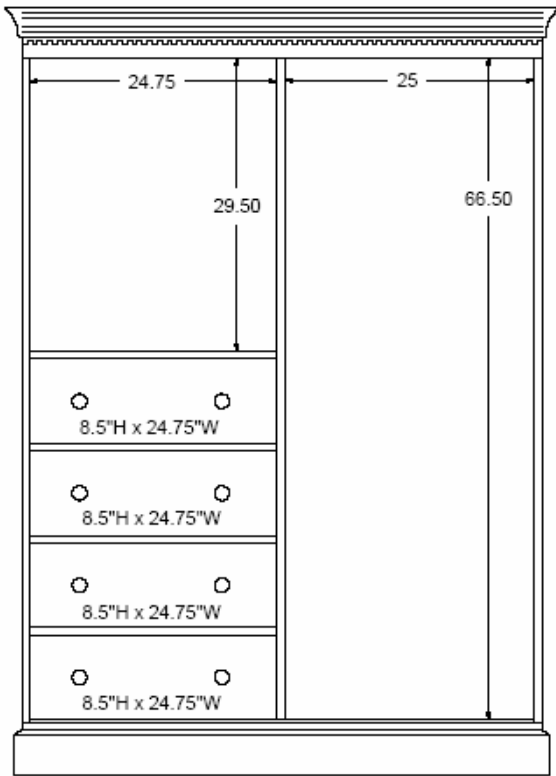

**Item # 97
English Armoire**

- Two Doors
- Split interior
- Dentil Molding
- Four Interior Drawers on Left
- Beadboard Backing interior
- 77H x 55.5W x 25D @ Crown
- Exterior: 77H x 52W x 23.25D
- Interior Depth: 22D
- Interior: See line drawing below

PHOTO

- Raised Panel Doors
- Seabrook Blue over Natural

All Door Styles available see Options



**Item # 96
Island Armoire**

- Split interior
- 5 adjustable shelves
- 2 Hanging Rods
- Beadboard Backing interior
- 70H x 43W x 23.5D @ Crown
- 20.5D Interior

PHOTO

- Bermuda Doors
- Palm

All Door Styles available, see Options



www.seabrookclassics.com
www.coastalwoodcraft.com

Phone: 843.466.0241 Fax: 843.466.0288

By **Coastal Woodcraft**

Entertainment Centers ... Page — 6



Item # 180
Half Entertainment Center

- Two Doors
- One Drawer
- Arched Base
- 51H x 43.75W x 23.75D @ Crown
- Interior opening 29.75H x 34W (20.5D inside)

PHOTO

- Plantation Shutter Doors
- Victorian White

All Door Options available, see Options



Item # 531
Plantation Half Entertainment Center

- 2 Doors
- Squared Feet
- Available as 531A, 531B or 531C. See chart below

PHOTO

- Plantation Shutter Doors
- Weathered White

All Door Options available, see Options

Item #	Dimensions @ Crown	Dimensions @ Cabinet	Interior Dimensions
531A	44.5W x 25.75D	46.75H x 42W x 24D	35.25H x 36W x 22D
531B	44.5W x 27.75D	46.75H x 42W x 26D	35.25H x 36W x 24D
531C	44.5W x 29.75D	46.75H x 42W x 28D	35.25H x 36W x 26D



www.seabrookclassics.com
www.coastalwoodcraft.com

Phone: 843.466.0241 Fax: 843.466.0288

By **Coastal Woodcraft**



Item # 542
Plantation Entertainment Center
Two Drawers

- Two Doors
- Two Drawers
- 68H x 39.5W x 25.75D @ Crown
- Interior: See line drawing below

PHOTO

- Plantation Shutter Doors
- Antique White

All Door Styles available, see Options.

Interior View

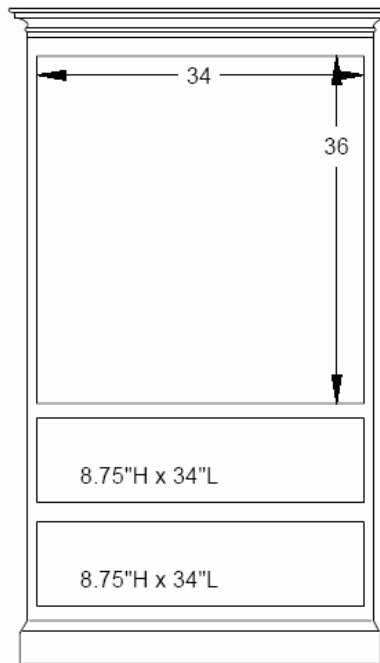

Side View

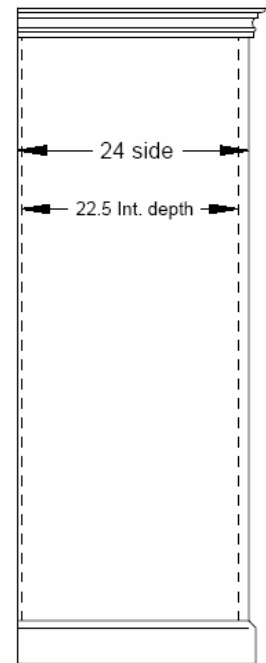

www.seabrookclassics.com
www.coastalwoodcraft.com

Phone: 843.466.0241 Fax: 843.466.0288

By Coastal Woodcraft

Entertainment Centers ... Page — 8



Item # 539
Plantation Medium Entertainment Center

- Four Doors
- One Fixed horizontal shelf divider
- 68H x 39.5W x 25.75D @ Crown
- Interior: See line drawing below

PHOTO

- Plantation Shutter Doors
- Beach

All Door Styles available, see Options.

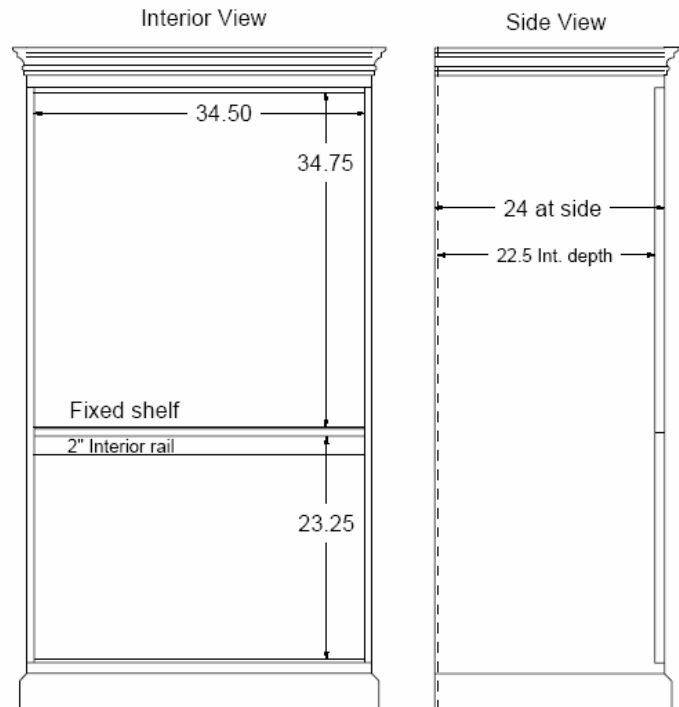

www.seabrookclassics.com
www.coastalwoodcraft.com

Phone: 843.466.0241 Fax: 843.466.0288

By **Coastal Woodcraft**



Item # CG530
Plantation Entertainment Center

- Four Doors
- Fixed horizontal divider
- 80H x 46.5W x 25.75D @ Crown
- Interior: See line drawing below

PHOTO

- Plantation Shutter Doors
- Seabrook Black over Tan

All Door Styles available, see Options

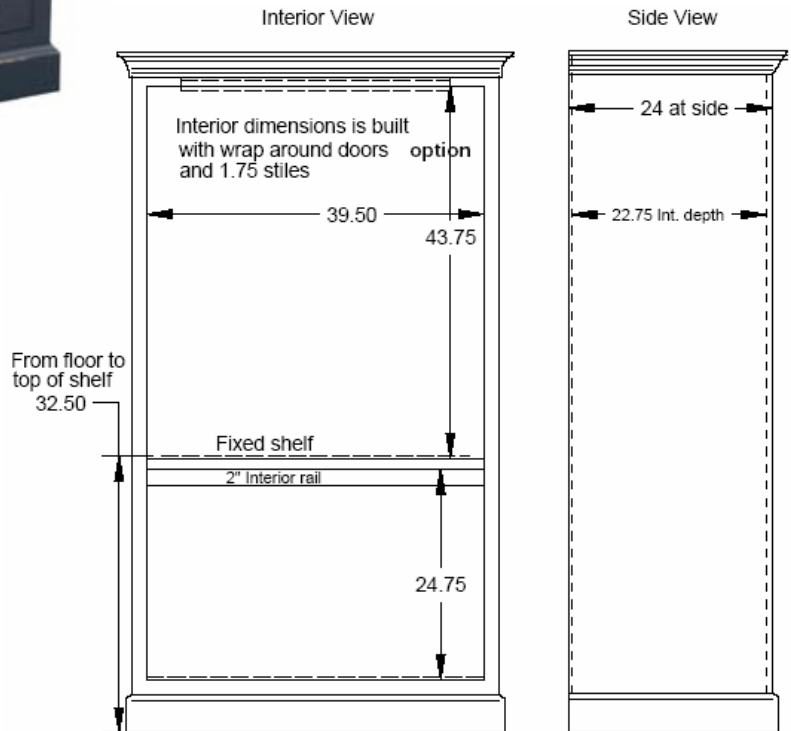

www.seabrookclassics.com
www.coastalwoodcraft.com

Phone: 843.466.0241 Fax: 843.466.0288

By Coastal Woodcraft



Arched bookcase with TV Lift in DOWN position



Arched bookcase with TV Lift in UP position

Item # 340 - 700

Arched Bookcase/TV Cabinet

Shown with Level II Heavy Rubbed
finish in Seabrook Black over Natural

This is the arched bookcase, Item #340, modified to accept a plasma TV lift. All chests / wall units can be modified to accept a plasma TV lift.

Remote/Rocker switch controlled plasma TV lift for up to 42" TV,
with 220lb capacity.

Lift manufactured by Venset.

Also available for Plasma TV's up to 65" (contact us for quote)



www.seabrookclassics.com
www.coastalwoodcraft.com

Phone: 843.466.0241 Fax: 843.466.0288

By **Coastal Woodcraft**

Entertainment Centers ... Page — 11

Item # 536
Plantation Linen Press



- Two Doors
- Three Drawers
- Dentil Molding
- Decorative Cut-out Base
- 77H x 39.5W x 22D @ Crown
- Interior: 18.75D x 32W x 34.5H

PHOTO (Left)

- Hand Carved Egret Doors OPTIONAL
- Antique White

All Door Styles available, see Options



Photo (Right)

- #536 Linen Press in Distressed Carolina Pine
- Optional Seagrass Doors
- Straight Base

All Door Options available, see Options



www.seabrookclassics.com
www.coastalwoodcraft.com

Phone: 843.466.0241 Fax: 843.466.0288

By Coastal Woodcraft

Buffets, Islands, and Huntboards

<u>Item</u>	<u>Page #</u>
Item # 555 Plantation Buffet	2
Item # 218 Three Door Buffet	2
Item # 556 Plantation Buffet	2
Item # 300 Kitchen Island	3
Item # 159 Coosaw Huntboard	3
Item # 22HC Palmetto Huntboard	3
Item #558 Daufuskie Huntboard	4
Item # 715 Okatie Sideboard	4
Item # 303K4 Four Drawer Kitchen Island	5
Item # 303 Four Drawer Buffet	No Photo
Item # 303K8 Eight Drawer Kitchen Island	No Photo
Item # 545 Plantation Rolling Bar	5
Item # 306 Drayton Hall Buffet	6



www.seabrookclassics.com
www.coastalwoodcraft.com

Phone: 843.466.0241 Fax: 843.466.0288

By **Coastal**  **Woodcraft**



**Item # 555
Plantation Buffet**

- Four Doors
- Two Adjustable Shelves @ Center
- One Adjustable Shelf each Side
- 33.75H x 75W x 16.5D @ Top

PHOTO left

- Plantation Shutter Doors
- Antique White over Brown

*All Door Styles available,
see Options*



**Item # 218
Three Door Buffet**

- Three Doors
- Wood Knobs
- One Fixed Shelf across Interior
- Barrel Feet
- 33H x 60W x 16D @ Top

PHOTO left

- Two Raised Panel Doors
- One Bermuda Shutter Door
- Carolina Khaki over Brown

*All Door Styles available,
see Options*



**Item # 556
Plantation Buffet**

- Four Doors
- Two Adjustable Shelves @ Center
- One Adjustable Shelf each Side
- 33.75H x 68W x 16.5D @ Top

PHOTO left

- Open Panel Doors
- Seabrook Blue

*All Door Styles available,
see Options*



www.seabrookclassics.com
www.coastalwoodcraft.com

Phone: 843.466.0241 Fax: 843.466.0288

By **Coastal Woodcraft**



**Item # 300
Kitchen Island**

- Standard 3/4" Thick Top
- Two Drawers
- Fixed Shelf Below
- 35H x 36W x 25D @ Top

PHOTO left

- OPTIONAL Butcher Block Top priced separately
- Seabrook Black



**Item # 159
Coosaw Huntboard**

- Two Doors
- Two Center Drawers
- Tapered legs
- 40H x 48W x 16D

PHOTO left

- Flat Panel Doors
- Wetlands Green over Brick Red

All Door Styles available, see Options



**Item # 22HC
Palmetto Huntboard**

- Quarter Round Bead Trim on Three Deep Drawers
- Tapered legs
- 44H x 52W x 22D @ Top

PHOTO left

- Seabrook Black



www.seabrookclassics.com
www.coastalwoodcraft.com

Phone: 843.466.0241 Fax: 843.466.0288

By Coastal Woodcraft

NEW ITEM

Item # 558

Daufuskie Buffet

- Adjustable Shelf each side
- Two French trimmed drawers in center
- 6 tapered legs

PHOTO *right*

- Beadboard doors standard
- Shown in Seabrook Red

All door options available
See Options

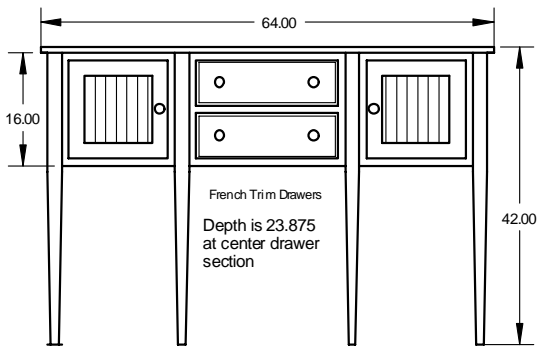

Item # 715
Okatie Side Board

- Bermuda doors
- 3 drawers each side
- 8 legs
- 72W x 40H x 21D

PHOTO *left*

- Shown in Seabrook Black over Antique White

All door options available
See Options



www.seabrookclassics.com
www.coastalwoodcraft.com

Phone: 843.466.0241 Fax: 843.466.0288

By **Coastal Woodcraft**



Item # 303K4

Four Drawer Kitchen Island

- Standard 3/4" Thick Top
- Four Drawers
- Fixed Shelf Below
- 35H x 60W x 25D @ Top

PHOTO *above*

- OPTIONAL Butcher Block Top-
priced separately
- Sunset

Item # 303

Four Drawer Buffet

- Four Drawers
- Fixed Shelf Below
- 34.5H x 50W x 22D @ Top

No photo

Item # 303K8

Eight Drawer Kitchen Island

Item is same as 303K4, however, 4 drawers are accessible from *two* sides of the island.

No photo



Item # 545

Plantation Rolling Bar

- Standard 3/4" Thick Top
- Two Doors
- Split Interior with Four Adjustable Shelves
- Shelf with Slats Below
- Square Legs with Casters
- 40H x 52W x 24D @ Top

PHOTO *left*

- Plantation Shutter Doors
- Sealed English on White Pine Top
- Seabrook Black over Tan



www.seabrookclassics.com

www.coastalwoodcraft.com

Phone: 843.466.0241 Fax: 843.466.0288

By **Coastal Woodcraft**

Page 103 of 138



Item # 306
Drayton Hall Buffet

- 2 Piece item
- 3 Arches in Hutch with Fluted Stiles
- 1 Fixed Shelf and 2 Adjustable Shelves in each section
- 3 Deep Drawers
- Planked Shelf
- 86H overall
- Hutch @ Top is 52H x 66W x 14.25D (10.5D Interior)
- Base @ Top is 34H x 64.5W x 22D

PHOTO

- Oyster Exterior and Palm Beadboard Interior



www.seabrookclassics.com

www.coastalwoodcraft.com

Phone: 843.466.0241 Fax: 843.466.0288

By **Coastal Woodcraft**

Tables

<u>Item</u>	<u>Page #</u>
Item # 304 English Cottage Coffee Table	2
Item # 252 Bermuda Coffee Table	2
Item # 580 Plantation Coffee Table	2
Item # 582 Plantation Coffee Table	No Photo
Item # 584 Island Hall Table	3
Item # 139 French Hall Table	3
Item # 583 Plantation Console Table	3
Item # 128 Farm Table	4
Item # 158Sofa Table	4
Item # 415 Tide Tray Table	5
Item # 416S Low Tide Coffee Table	5
Item # 416 Tide Coffee Table	5
Item # 261 Grove Park Coffee Table	6
Item # 298 Grove Park End Table	6
Item # 269 Grove Park Console Table	6
Item # 185 Half Round Table	7
Item # 305 Cricket Table	7
Item # 305M Small Cricket Table	7
Item # 187 Sea Island Coffee Table	7
Item # 20HC Legare Table	8
Item # 20HCP Legare Table	No Photo
Item # 30HC The Battery Table	8
Item # 31HC The Battery Table—SMALL	8
Item # 182 Sheldon Table	9
tem #186 Round Dining Table	9
Monterey Collection	10



www.seabrookclassics.com

www.coastalwoodcraft.com

Phone: 843.466.0241 Fax: 843.466.0288

By **Coastal**  **Woodcraft**

Page 105 of 138



**Item # 304
English Cottage
Coffee Table**

- Turned Legs
- One Drawer
- 18H x 40W x 28D

PHOTO left

- Victorian White

Refer to Options Page



**Item # 252
Bermuda Coffee Table**

- Recessed Fixed Bermuda Shutter
- Straight Skirt
- Tapered Legs
- 20H x 38W x 26D

PHOTO left

- Palm

Refer to Options Page



**Item # 580
Plantation Coffee Table**

- Square Legs
- Routed Edge Table Top
- 19.5H x 38.75W x 39.5D

PHOTO left

- Seabrook Black

**Item # 582
Plantation Coffee Table**

- Square Legs
- Routed Edge Table Top
- 20.25H x 39.5W x 24.25D

PHOTO Not shown



www.seabrookclassics.com

www.coastalwoodcraft.com

Phone: 843.466.0241 Fax: 843.466.0288

By **Coastal Woodcraft**



Item # 584
Island Hall Table

- Two Doors
- Wood Knobs
- 33.75H x 47W x 12.75D @ Chamfer Top
- Opening 24W. Interior 9.5D

PHOTO left

- Key Lime
- Plantation Shutter Doors

All Door Styles available, see Options

Item # 139
French Hall Table

- 30H x 45W x 16D @ Top

PHOTO right

- Top: Sealed English on Pine
- Base: Victorian White



Item # 583
Plantation Console Table

- Item is Standard with Plantation Shutter Panel
- *Shown with Optional Bermuda Shutter*
- Fixed shelf below
- Furniture Finish
- 30H x 57.5W x 17D @ Top

PHOTO left

- OPTIONAL Bermuda Shutter Panels
- Lime Zinger



www.seabrookclassics.com
www.coastalwoodcraft.com

Phone: 843.466.0241 Fax: 843.466.0288

By Coastal Woodcraft



Item # 128 Farm Table

- Turned Farm Style Legs

Standard Dimensions

- A 30H x 34W x 34D
- B 30H x 45W x 34D
- C 30H x 54W x 34D
- D 30H x 60W x 34D
- E 30H x 72W x 34D
- F 30H x 84W x 36D
- G 30H x 96W x 36D
- H 30H x 120W x 36D

See price list for leaf options and other dimensions



PHOTO Top left

- Top: CUSTOM Hardwood—
Seabrook Sealed Heart Pine Top
- Base: Weathered White Base

PHOTO left

- Top and Base; Victorian White

Available in Custom Dimensions
Smooth or Planked Top



**Item # 158
Sofa Table**

- One Drawer
- Turned legs
- 30H x 49W x 16D

PHOTO left

- Top and Base: CUSTOM Hardwood
- Seabrook Sealed Heart Pine
- OPTIONAL Bail Handles



www.seabrookclassics.com

www.coastalwoodcraft.com

Phone: 843.466.0241 Fax: 843.466.0288

By **Coastal Woodcraft**



Item # 415
Tide Tray Table

- Three Tier Beadboard Shelving
- 36H x 28W x 18D @ Top

PHOTO *left*

- Sunset



Item # 416S
Low Tide Coffee Table

- 2 Tier Beadboard Shelving
- 19.5H x 38W x 19.5D

PHOTO *left*

- Ricefield



Item # 416
Tide Coffee Table

- Two Tier Beadboard Shelving
- 19.25H x 38W x 38D @ Top

PHOTO *left*

- Lime Zinger



www.seabrookclassics.com
www.coastalwoodcraft.com

Phone: 843.466.0241 Fax: 843.466.0288

By Coastal Woodcraft

The Grove Park Collection

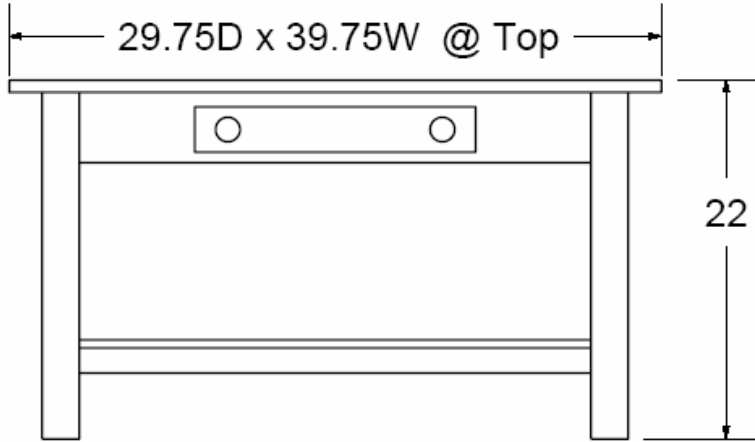

Item # 261
Grove Park Coffee Table

- One Drawer
- One Shelf
- 22H x 39.75W x 29.75D

LINE DRAWING *left*

- Item # 298
Grove Park End Table
- One Drawer
 - One Shelf
 - 24.5H x 24W x 27D

PHOTO *right*

- Top: Distressed Carolina Pine
- Base: Antique White over Brown

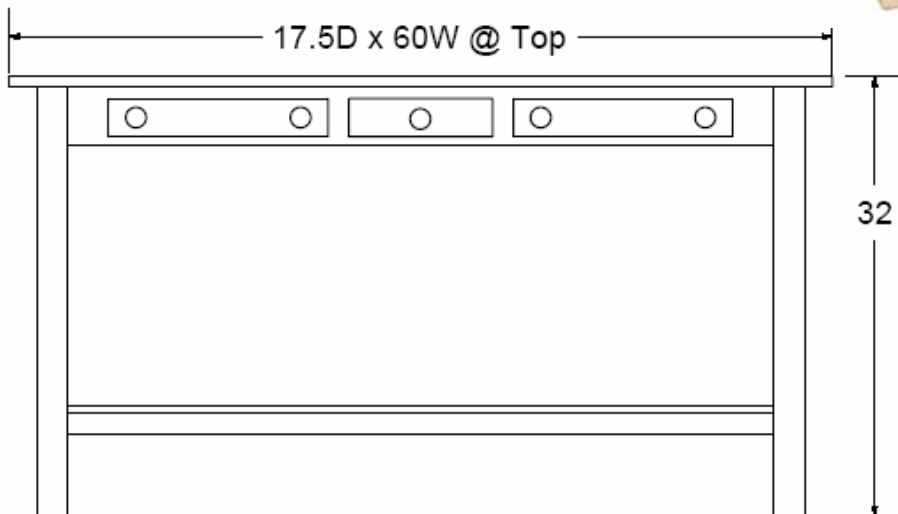

Item # 269
Grove Park Console Table

- Three Drawers
- One Shelf
- 32H x 60W x 17.5D

LINE DRAWING *left*



www.seabrookclassics.com

www.coastalwoodcraft.com

Phone: 843.466.0241 Fax: 843.466.0288

By Coastal Woodcraft



Item # 185
Half Round Table

- Shelf
- 29.5H x 30W x 15D @ Top

PHOTO *left*

- Frogmore Green



Item # 305
Cricket Table

- 30H x 30D
- Round Top

PHOTO *left*

- Victorian White

Item # 305M
Small Cricket Table

- 30H x 18D
- Round Top

PHOTO *right*

- Victorian White over Flamingo



Item # 187
Sea Island Coffee Table

- 18H x 42 Diameter Round Top
- Round over Top with Bead Trim
- Pedestal Base

PHOTO *left*

- Island blue

Custom sizes available



www.seabrookclassics.com

www.coastalwoodcraft.com

Phone: 843.466.0241 Fax: 843.466.0288

By Coastal Woodcraft



**Item # 20HC
Legare Table**

- Single Pedestal Base
- Curved Skirt
- 30.75H x 46 Round Top comes standard in Sealed **Heart Pine*

**Item # 20HCP
Legare Table**

- Painted Top and Base
 - 30.5 x 46 Round Top comes standard painted
- Not shown*

PHOTO *below* in Seabrook Blue



PHOTO *above*

- Base: Weathered White
 - Top: Sealed Heart Pine
- *All other items Heart Pine are custom*



**Item # 30HC
The Battery Table**

- Half Round Table
- Tapered Legs
- Curved Skirt
- 29H x 59W x 24D

PHOTO *above* in Antique White

Item # 31HC The Battery Table—SMALL

- Half Round Table
- Tapered Legs
- Curved Skirt
- 29H x 45W x 18D

PHOTO *left*



www.seabrookclassics.com
www.coastalwoodcraft.com

Phone: 843.466.0241 Fax: 843.466.0288

By **Coastal Woodcraft**



Item # 182
Sheldon Table

- Inverted Route on Top Edge
- Tapered Legs
- Curved Skirt
- 30H x 34 Square @ Top
- 25.5 between legs

PHOTO left

- Regatta



Item #186
Round Dining Table

(A base with four legs is standard.
If single pedestal is preferred
please specify)

Standard Dimensions

- A 30H x 32D
- B 30H x 34D
- C 30H x 36D
- D 30H x 38D
- E 30H x 42D
- F 30H x 48D
- G 30H x 60D

Available in Custom Dimensions

Top on Single Pedestal Base cannot
exceed 60"

PHOTO left

- Top: Sealed English on White Pine Top
- Base: Turned Leg Base in Wetlands Green

Single Pedestal Option

PHOTO right

- Seabrook Red



www.seabrookclassics.com

www.coastalwoodcraft.com

Phone: 843.466.0241 Fax: 843.466.0288

By Coastal Woodcraft

Visit us at www.seabrookclassics.com

The Monterey Collection



Dimensions Shown:
44" w x 18" h x 18"d

Custom dimensions available.

Simple, understated elegance.

The Monterey coffee and end table (not shown) in cherry with a satin clear coat makes the ultimate understatement in refined taste. The clear coat accentuates the natural beauty of the grain, and our unique construction method wraps the grain across the top and seamlessly down the sides to the floor. This piece is available in custom dimensions in walnut, cherry, oak, or paint grade. See it in our Atlanta showroom.

Visit our website for more selections from the Monterey Collection, including chest of drawers, headboard, and end table.



www.seabrookclassics.com
www.coastalwoodcraft.com

Phone: 843.466.0241 Fax: 843.466.0288

By **Coastal**  **Woodcraft**

Page 114 of 138

Side Tables and End Tables

<u>Item</u>	<u>Page #</u>
Item # 32HC Concord Side Table	2
Item # 171 Two Drawer Side Table	2
Item # 130 Side Table	2
Item # 251 Bermuda End Table	3
Item # 581 Plantation End Table	3
Item # 417 Tide Side Table	3
Item # 509 Seagrass Nightstand	4
Item # 520 Dockside Nightstand	4
Item # 535 Open Nightstand	4
Item # 135 Cottage Nightstand	5
Item # 540 Beaufort Side Table	5
Item # 122 Basket Weave Nightstand	5
Item # 528 Nightstand with Drawer	6
Item # 528F Fish Nightstand	6
Item # 532 Plantation Nightstand	6
Item # 514 Oglethorpe Nightstand	6
Item # 508 Sea Island End Table	7
Item # 510 Two Door Plantation Nightstand	7



www.seabrookclassics.com

www.coastalwoodcraft.com

Phone: 843.466.0241 Fax: 843.466.0288

By **Coastal**  **Woodcraft**



Item # 32HC
Concord Side Table

- Round Top
- 1 Drawer in front
- Turned Legs
- 29H x 22 Round Top

PHOTO left

- Victorian over Seamist

Item # 171
Two Drawer Side Table

- Two Drawers
- Wood Knobs
- 29H x 22W x 22D @ Top

PHOTO right

- OPTIONAL Bail Handles
- Victorian White

See Options page



Item # 130
Side Table

- One Drawer
- Wood Knob
- 30H x 20W x 20D @ Top

PHOTO left

- Top: Tan
- Base: Seabrook Blue over Tan

See Options page



www.seabrookclassics.com
www.coastalwoodcraft.com

Phone: 843.466.0241 Fax: 843.466.0288

By **Coastal Woodcraft**



Item # 251
Bermuda End Table

- Tapered Legs
- Bermuda Shutter Panel Top
- 27H x 20W x 20D @ Top

PHOTO left

- Bayside

Item # 581
Plantation End Table

- Door Opens for Inside Storage
- 28.75H x 23W x 21D @ Top

PHOTO right

- Antique White over Frogmore Green



Item # 417
Tide Side Table

- Beadboard Top and Shelf
- 26H x 18W x 18D @ Top

PHOTO left

- Sun Porch



www.seabrookclassics.com

www.coastalwoodcraft.com

Phone: 843.466.0241 Fax: 843.466.0288

By **Coastal Woodcraft**



Item # 509
Seagrass Nightstand

- One Drawer
- Bun Feet
- 24.5H x 22W x 17D
- Interior Depth: 14.5D

PHOTO left

- Square Seagrass Door
- Victorian White

All Door Styles available, see Options.

Item # 520
Dockside Nightstand

- Rope Trim
- Framed Flat Panel on Sides
- Two Drawers English Bead Trim
- One Open Shelf
- Old South Turned Feet
- 30H x 22.5W x 17.25D
- Drawers 6.75H, Open shelf 15D x 18.5W

PHOTO right

- Regatta over Natural, light rub
- See price list for option to customize with additional drawer, in place of open shelf.
Refer to Options Page*



Item # 535
Open Nightstand

- One Drawer
- Bun Feet
- 27H x 21W x 18D
- Interior Depth: 16.75D

PHOTO left

- Antique White over Brown

Refer to Options Page



www.seabrookclassics.com
www.coastalwoodcraft.com

Phone: 843.466.0241 Fax: 843.466.0288

By Coastal Woodcraft



Item # 135
Cottage Nightstand

- French Legs
- 3 Drawers
- 30.5H x 26W x 19D

PHOTO left

- Weathered White

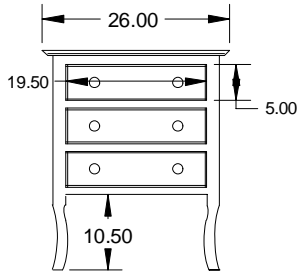

Item # 540
Beaufort Side Table

- Bracket Feet
- 3 Drawers
- 33H x 20W x 18D

PHOTO right

- Victorian White

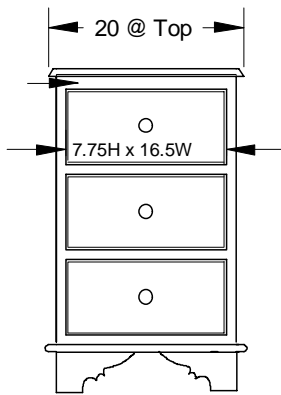

Item # 122
Basket Weave Nightstand

- Drawer
- Basket Weave on Fixed Shelf
- Tapered Legs and Small Tulip Feet
- 31H x 25W x 19.75D

PHOTO left

- Seabrook Black



www.seabrookclassics.com

www.coastalwoodcraft.com

Phone: 843.466.0241 Fax: 843.466.0288

By **Coastal Woodcraft**

Visit us at www.seabrookclassics.com



**Item # 528
Nightstand with Drawer**

- One Drawer
- One Door
- One Fixed Shelf
- Arched Base
- 30H x 15.5W x 13.75D

PHOTO left

- Plantation Shutter Door
- Flamingo

*All Door Styles available,
see Options*

**Item # 528F
Fish Nightstand**

PHOTO right

- Fish Cut-out Door
- Straight Base
- Seabrook Blue

*Same as Item # 528, but standard
with Straight Base, and Fish Door*



**Item # 532
Plantation Nightstand**

- One Door
- One Fixed Shelf
- 25.25H x 21W x 14.5D

PHOTO above

- Plantation Shutter Door
- Seabrook Blue

All Door Styles available, see Options



**Item # 514
Oglethorpe Nightstand**

- One Drawer
- Open Shelf
- Beadboard Backing
- 30H x 30W x 19D
- Oglethorpe Feet

PHOTO above

- Weathered White



www.seabrookclassics.com
www.coastalwoodcraft.com

Phone: 843.466.0241 Fax: 843.466.0288

By **Coastal Woodcraft**

Item # 508

Sea Island End Table

- One Drawer
- Two Doors
- Wood Knobs
- One Adjustable Shelf
- 32H x 26W x 18.5D @ Crown
- Inside Depth: 16D



PHOTO right

- Open Panel Doors (Open Panel Doors with Wooden Fabric Rods)
- Hibiscus over St Croix

PHOTO Above left closed

PHOTO Lower Left open

- Plantation Shutter Doors
- Oyster



All Door Styles available, see Options

Item # 510

Two Door Plantation Nightstand

PHOTO below

- Two Doors
- Wood Knobs
- One Fixed Shelf
- 27H x 23.5W x 17D @ Crown
- Inside Depth: 15D
- Fish Cut-out Doors
- Bayside

All Door Styles available, see Options

PHOTO below

- Two Doors
- Wood Knobs
- One Fixed Shelf
- 27H x 23.5W x 17D @ Crown
- Inside Depth: 15D
- Palm Cut-out Doors
- Palm

All Door Styles available, see Options



www.seabrookclassics.com

www.coastalwoodcraft.com

Phone: 843.466.0241 Fax: 843.466.0288

By **Coastal Woodcraft**



by **Coastal**  **Woodcraft**

Orders or Inquiries
843.466.0241

Fax
843.466.0288

Email
Info@seabrookclassics.com



www.seabrookclassics.com
www.coastalwoodcraft.com

Phone: 843.466.0241 Fax: 843.466.0288

By **Coastal**  **Woodcraft**

Mirrors, Benches, and Screens

<u>Item</u>	<u>Page #</u>
Item # 93 Large Palmetto Mirror Frame	2
Item # 93M Small Palmetto Mirror Frame	2
Item #90 Melrose Mirror Frame	3
Item # 94 Dockside Mirror Frame	3
Item # 91 Oglethorpe Mirror Frame	3
Item # 710 Fish Bench	4
Item # 712 Mulberry Bench	4
Item # 710P Palmetto Bench	4
Item # 711 Scroll Side Bench	5
Item # 95 Lowcountry Screen	5
Item # 92 English Cottage Screen	5



www.seabrookclassics.com
www.coastalwoodcraft.com

Phone: 843.466.0241 Fax: 843.466.0288

By **Coastal**  **Woodcraft**



Item # 93
Large Palmetto Mirror Frame

Glass not included

- French Trim
- Palm Cut-outs
- 41H x 56W x 1D @ Top of Cut-Outs

PHOTO left

- Hibiscus with Palmetto Cut-Outs

Please specify cut-out preference on order.

- Palmettos
- Boats
- Pelicans
- Crabs

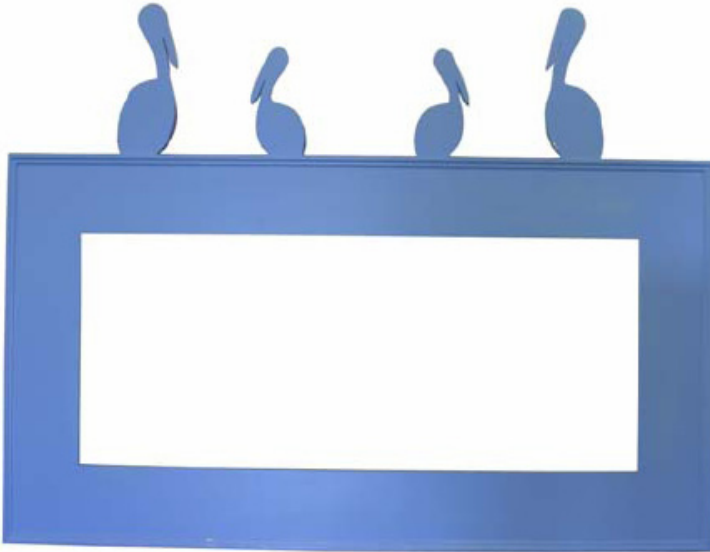
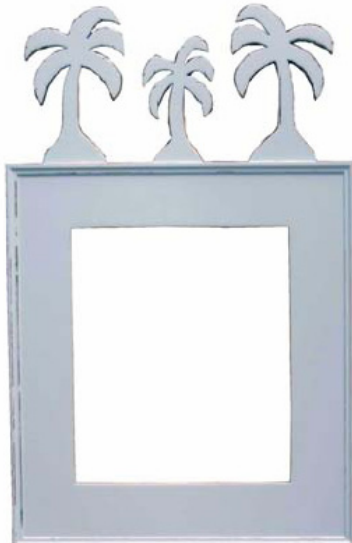

PHOTO left

- Bayside with Pelican Cut-Outs



Item # 93M
Small Palmetto Mirror Frame

Glass not included

- Bead Trim around Frame
- Palm Cut-Outs
- 38H x 24W x 1D

PHOTO left

- Mint Julep with Palmetto Cut-Outs

PHOTO right

- Bayside with Crab Cut-Outs

Please specify cut-out preference on order.



www.seabrookclassics.com
www.coastalwoodcraft.com

Phone: 843.466.0241 Fax: 843.466.0288

By **Coastal Woodcraft**

Item #90
Melrose Mirror Frame
Glass not included

- Bead Trim around Frame
- 43H x 30W x 1D

PHOTO *right*

- Seabrook Yellow

(Custom sizes available)



Item # 94
Dockside Mirror Frame
Glass Not Included

- Rope Trim inside route
- 33H x 40W x 1.5D

PHOTO *left*

- Seabrook Black over Brown
(Custom sizes available)



Item # 91
Oglethorpe Mirror Frame
Glass Not Included

- Crown
- Step Out Stiles
- 35H x 45W x 2.75D

PHOTO *left*

- Oyster Roast

(Custom sizes available)



www.seabrookclassics.com
www.coastalwoodcraft.com

Phone: 843.466.0241 Fax: 843.466.0288

By **Coastal Woodcraft**

**Item # 710
Fish Bench**

- Slat Back with Fish Cut-outs
- Shelf Below
- 34.75H x 49W x 18.25D

PHOTO left

- Fish Cut-outs
- Sunset

*Whale Cut-Outs also available.
Please specify cut-out preference on order.*



**Item # 712
Mulberry Bench**

- Slat Back
- Shelf Below
- 34.75H x 49W x 18.25D

PHOTO left

- Bayside over Lime Zinger
- OPTIONAL Monogram (priced separately)

Monogram

(See Monogram Options)

- Style: Octogram
- Lime Zinger



**Item # 710P
Palmetto Bench**

- Flat Panel Back with Palm Cut-outs
- Shelf Below
- 34.75H x 49W x 18.25D

PHOTO right

- OPTIONAL Palm Cut-outs
- Seabrook Blue

Please specify cut-out preference on order.

- Palmettos
- Whales
- Pelicans
- Boats



www.seabrookclassics.com
www.coastalwoodcraft.com

Phone: 843.466.0241 Fax: 843.466.0288

By **Coastal Woodcraft**

Item # 711
Scroll Side Bench

- Plantation Shutter Sides
- Curved Skirt & Rails
- 32.5H x 32W x 18.25D

PHOTO right

- St Croix



Item # 95
Lowcountry Screen

- Two Bermuda Shutters
- Palmetto & Moon Cut-out
- 72H x 44W
- Each Panel: 2W



PHOTO left

- Margarita over Flamingo

Item # 92

English Cottage Screen

- Three Plantation Shutters (functional)
- 72H x 36.5W
- Each Panel: 12W

PHOTO right

- Hibiscus

Additional Panels available



Please specify cut-out preference on order.

- Palmetto & Moon
- Palmetto as on Item #710P
- Boat
- Pelican

Additional Panels available



www.seabrookclassics.com
www.coastalwoodcraft.com

Phone: 843.466.0241 Fax: 843.466.0288

By **Coastal Woodcraft**



by **Coastal**  **Woodcraft**

Orders or Inquiries
843.466.0241

Fax
843.466.0288

Email
Info@seabrookclassics.com



www.seabrookclassics.com
www.coastalwoodcraft.com

Phone: 843.466.0241 Fax: 843.466.0288

By **Coastal**  **Woodcraft**

Wall Units and Armoires

<u>Item</u>	<u>Page #</u>
Item # 114 Old Point Armoire	2
Item # W155 Broad River Wall Unit	2
Item # W131 Classic Bookcase Wall Unit	3
Item # W132 Three Piece Cottage Wall Unit	4
Item # W140 Lowcountry Wall Unit	5
Item # W145 High Tide Wall Unit	6
Item # W150 Brunswick Wall Unit	7
Item # W160 Sea Island Wall Unit	8
Item # W165 Maybank Wall Unit	9



www.seabrookclassics.com
www.coastalwoodcraft.com

Phone: 843.466.0241 Fax: 843.466.0288

By **Coastal**  **Woodcraft**



Item # 114
Old Point Armoire

- Two Piece Wall Unit
- Four Doors upper unit
- Large Center Compartment with Two Small Side
- Three Adjustable Shelves in each Small Side
- BASE:: Six Drawers
- 89H x 79W x 28D @ Crown
- Center Compartment: 44H x 40W x 25D

PHOTO

- Plantation Shutter Doors
- Brick Red over Antique White with Medium Rub

All Door Styles available, see Options.



Item # W155
Broad River Wall Unit

- Four Piece Wall Unit
- CENTER: Two Piece Center Unit
- Top: Doors
- Base: Three Drawers
- SIDES: Stepback
- Top: Three Adjustable Shelves
- Base: Three Drawers
- 96H x 84.5W x 24.75D @ Crown

PHOTO

- Bermuda Shutter Doors
- Victorian White exterior
- Gumbo Beadboard Backing

All Door Styles available, see Options.



www.seabrookclassics.com
www.coastalwoodcraft.com

Phone: 843.466.0241 Fax: 843.466.0288

By Coastal Woodcraft

Item # W131
Classic Bookcase Wall Unit

- Three Piece Wall Unit

CENTER

- Top: Open
- Base: Doors

SIDES

- Top: Open
- Three Adjustable Shelves each Side Unit
- Base: Doors
- Wrap around Crown
- Beadboard Backing
- 83H x 87W x 21.75D @ Crown
- Interior: See line drawing below

PHOTO

- Victorian White
- Plantation Shutter Doors



All Door Styles available, see Options.

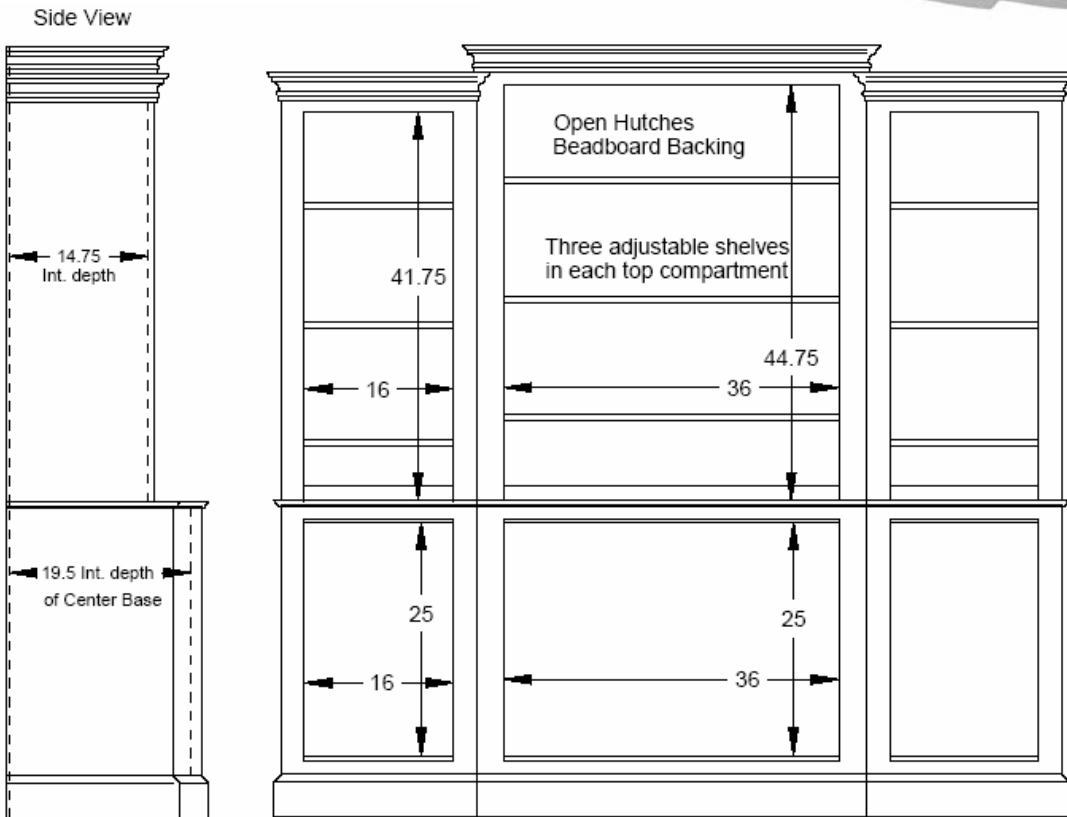

www.seabrookclassics.com
www.coastalwoodcraft.com

Phone: 843.466.0241 Fax: 843.466.0288

By Coastal Woodcraft

Wall Units and Armoires ... Page — 3

Item # W132
Three Piece Cottage Wall Unit

CENTER

- Top: Doors
- Base: Doors

SIDES

- Top: Open
- Three Adjustable Shelves
- Base: Doors
- Crown Molding
- Beadboard Backing
- 96H x 12.5W x 25D @ Crown
- Interior: See line drawing below

PHOTO

- Antique White
- Bermuda Shutter Doors
- Raised Panel Doors

*All Door Styles available,
see Options.*



Side View

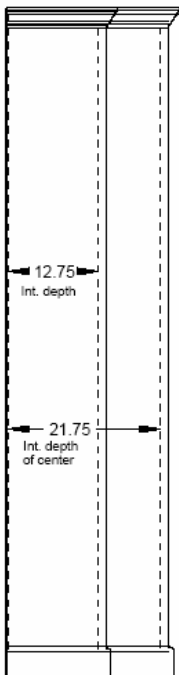

Interior View

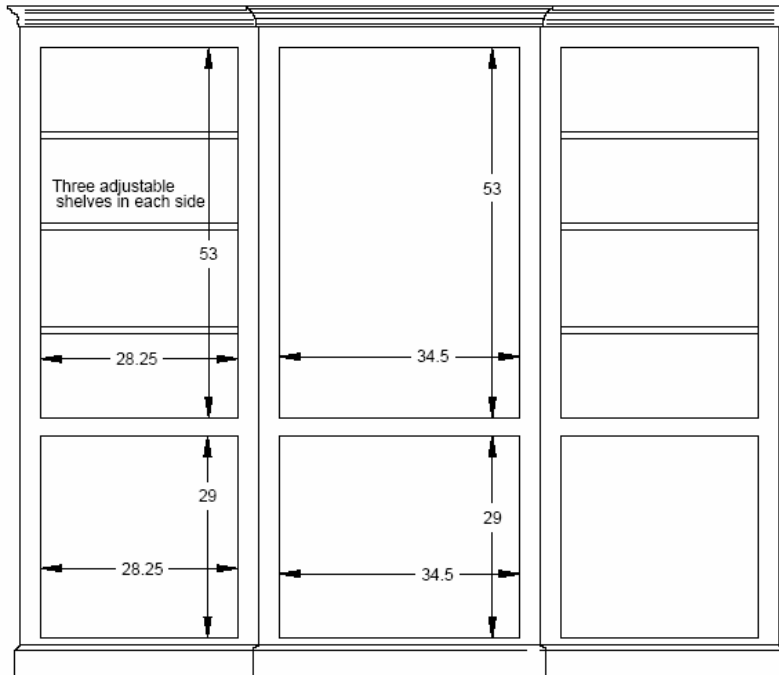

www.seabrookclassics.com
www.coastalwoodcraft.com

Phone: 843.466.0241 Fax: 843.466.0288

By Coastal Woodcraft

Item # W140

Lowcountry Wall Unit

- Four Piece Wall Unit

CENTER: Two Piece

- Top: Doors
- Base: Doors

SIDES

- Top: Open
- Three Adjustable Shelves
- Base: Doors
- Beadboard Backing
- 80H x 102.5W x 25.5D@ Crown

Interior:

See line drawing below

PHOTO

- Seabrook Black
- Plantation Shutter Doors



All Door Styles available.

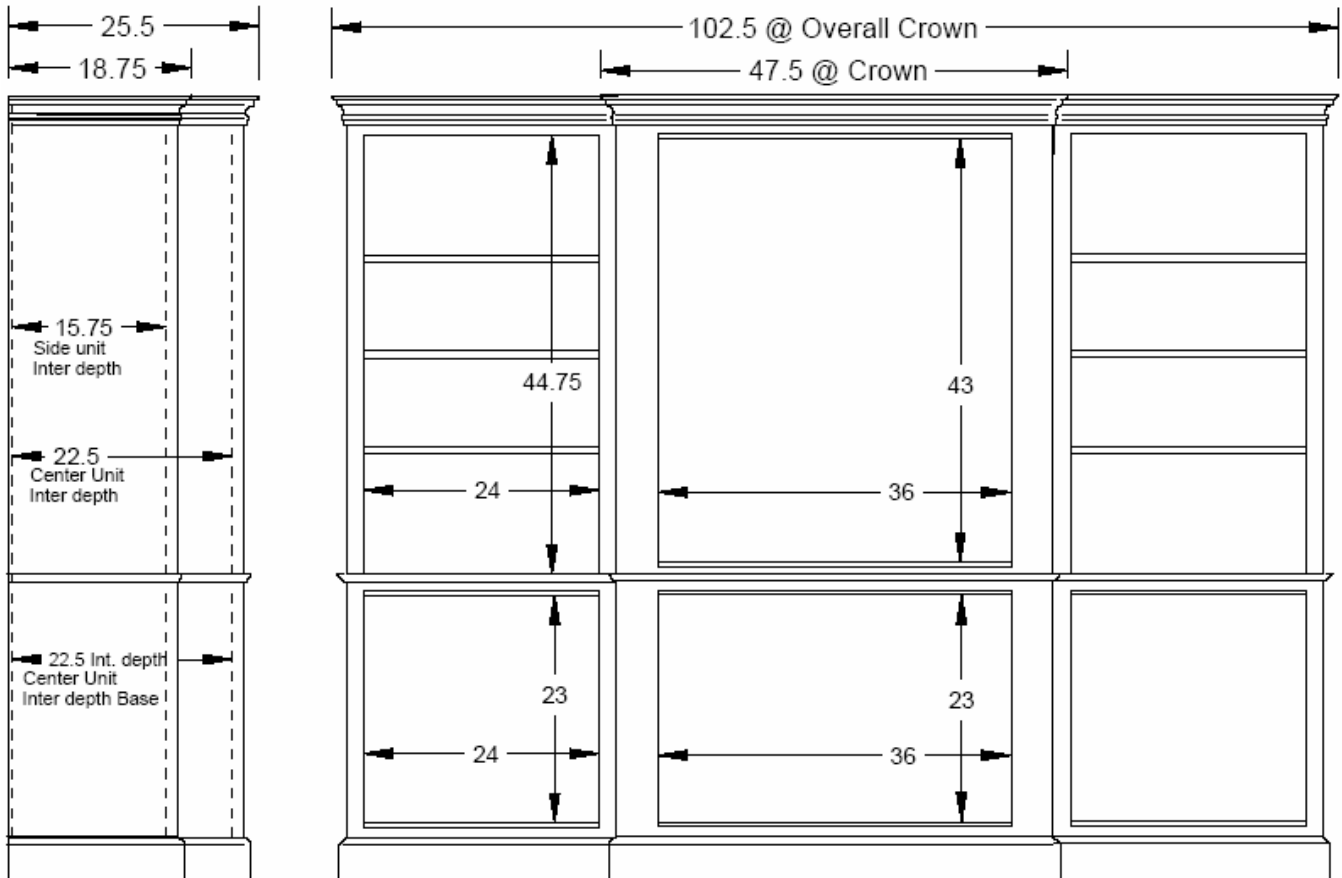

www.seabrookclassics.com

www.coastalwoodcraft.com

Phone: 843.466.0241 Fax: 843.466.0288

By Coastal Woodcraft

Page 133 of 138



**Item # W145
High Tide Wall Unit**

Accommodates Wide Screen Televisions

- Three Piece Wall Unit

CENTER

- Bi-Fold Doors

SIDES

- Open Hutch
- 2 Adjustable Shelves
- One Door
- Fixed Interior Split Shelf @ Top for DVD, VCR, etc
- 5.75H x 23.5 W x 20.5D
- 75H x 105.5W x 23.5D @ Crown
- Interior Center Compartment: 64H x 48W x 20.5D
- Interior Center below Split Shelf: 57H

PHOTO

- Victorian White with Veranda Green Bead-board Back
- Plantation Shutter Doors

All Door Styles available, see Options



www.seabrookclassics.com
www.coastalwoodcraft.com

Phone: 843.466.0241 Fax: 843.466.0288

By **Coastal Woodcraft**

Item # W150

Brunswick Wall Unit

- Four Piece Wall Unit

CENTER: Two Pieces

- Top: Two Bi-Fold Doors
- Base: Four Doors

SIDES

- Top: Two Adjustable Shelves
- Base: One Door each Side
- 84H x 17.5W x 23.5D @ Crown
- Interior: See line drawing below

PHOTO

- Victorian White
- Bermuda Shutter Doors



*All Door Styles available,
see Options*

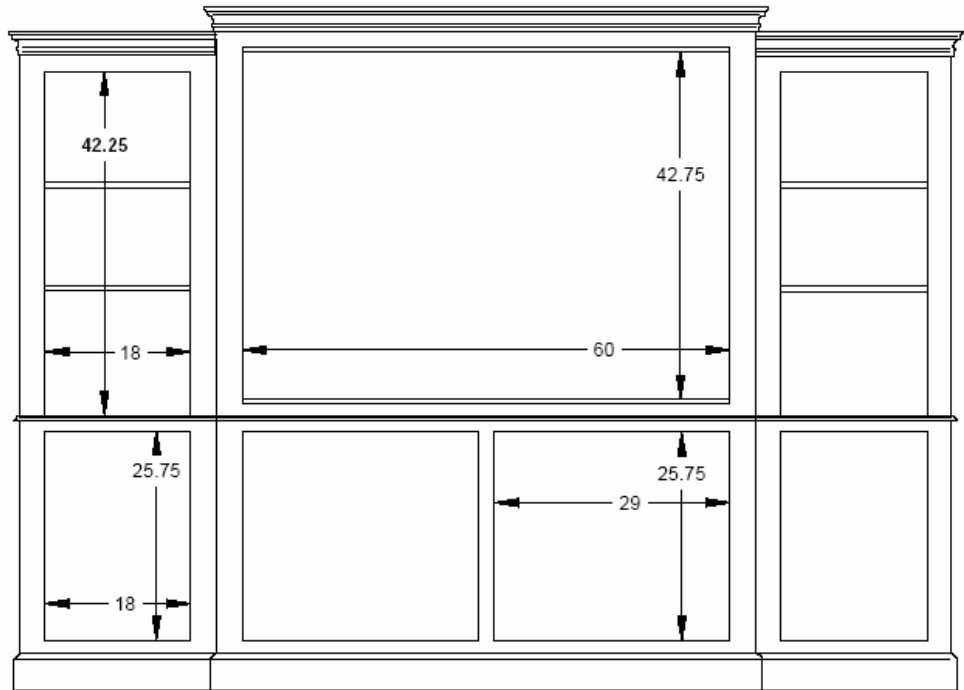
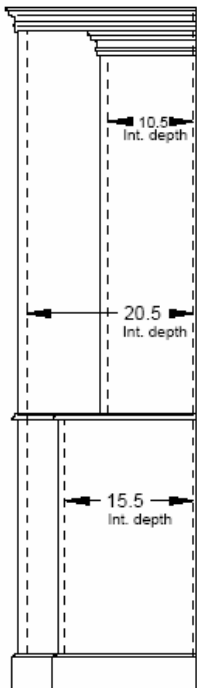

www.seabrookclassics.com
www.coastalwoodcraft.com

Phone: 843.466.0241 Fax: 843.466.0288

By **Coastal Woodcraft**

Item # W160
Sea Island Wall Unit

- Four Piece Wall Unit

CENTER:

- Two Piece Center Unit
- Top: Doors
- Base: Doors

SIDES

- Top: Open
- Three Adjustable Shelves
- Base: Door
- Beadboard Backing
- 75H x 94.5W x 25.75D @ Crown
- Interior: See line drawing below

PHOTO

- Seabrook Black over Natural
- Raised Panel Doors

All Door Styles available,
see Options

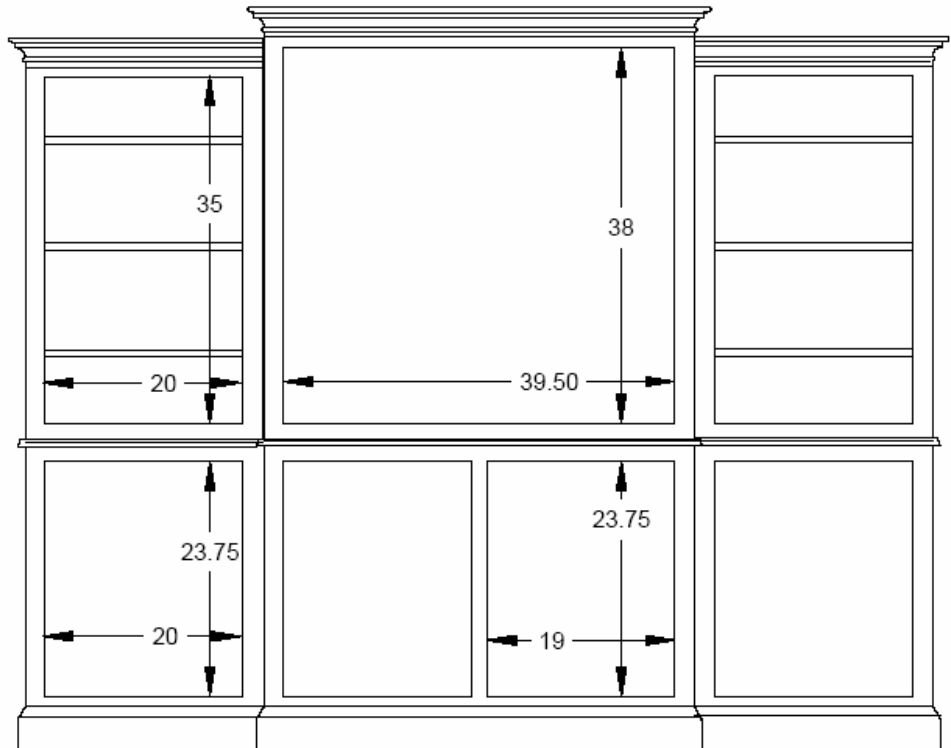
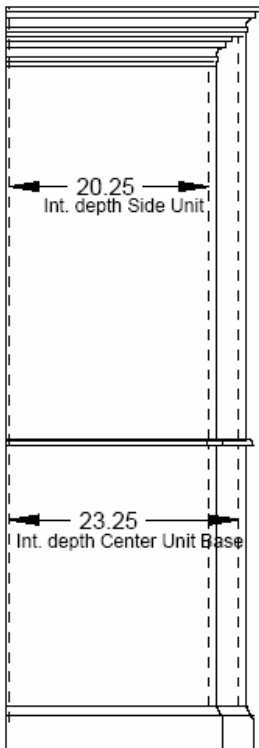

www.seabrookclassics.com
www.coastalwoodcraft.com

Phone: 843.466.0241 Fax: 843.466.0288

By Coastal Woodcraft



Item # W165
Maybank Wall Unit

PHOTO

- Victorian White over Brown
- Shown with Basket Weave Doors



Item # W165
Maybank Wall Unit

Accommodates many Wide Screen Televisions

- 2 Piece Wall Unit
- Hutch has Bi-Fold Doors
- Opened Center is 37.5H x 48W x 13D above Fixed Shelf and Cubicles
- 73H x 7W x 16.5D @ Hutch Crown (78.5D x 20.25D @ Base Top)

Other Door Options available



www.seabrookclassics.com
www.coastalwoodcraft.com

Phone: 843.466.0241 Fax: 843.466.0288

By **Coastal Woodcraft**

Wall Units and Armoires ... Page — 9



by Coastal  Woodcraft

Orders or Inquiries
843.466.0241

Fax
843.466.0288

Email
Info@seabrookclassics.com



www.seabrookclassics.com
www.coastalwoodcraft.com

Phone: 843.466.0241 Fax: 843.466.0288

By Coastal  Woodcraft